



National Kaohsiung  
CENTER FOR THE ARTS

WEI WU YING 衛武營

國家藝術文化中心

國家表演藝術中心 National Performing Arts Center

## CONCERT HALL

### Technical Information

# Table of Contents

|                                                        |           |
|--------------------------------------------------------|-----------|
| <b>1 General Information</b>                           | <b>1</b>  |
| 1-1 National Kaohsiung Center for the Arts (WEIWUYING) | 1         |
| 1-2 Concert Hall                                       | 1         |
| 1-3 Traffic Information                                | 2         |
| 1-4 Contact Information                                | 2         |
| 1-5 Stage door                                         | 2         |
| 1-6 Auditorium / Seating                               | 3         |
| 1-7 Concert Hall Plan                                  | 5         |
| 1-8 Concert Hall Section                               | 7         |
| <b>2 Stage</b>                                         | <b>8</b>  |
| 2-1 Stage                                              | 8         |
| 2-2 Hoisting                                           | 8         |
| 2-3 Stage Elevation Platform                           | 9         |
| 2-4 Acoustic Panel                                     | 9         |
| <b>3 Lighting</b>                                      | <b>10</b> |
| 3-1 Lighting System                                    | 10        |
| 3-2 Lighting Instrument                                | 11        |
| 3-3 Accessories                                        | 12        |
| 3-4 Lighting DMX system                                | 15        |
| 3-5 Lighting Circuit                                   | 16        |
| 3-6 Portable Lift                                      | 20        |
| 3-7 Additional Power Supply                            | 20        |
| 3-8 Working Light / Auditorium Light                   | 20        |
| <b>4 Audio/Video Systems</b>                           | <b>21</b> |
| 4-1 Audio Facilities                                   | 21        |
| 4-2 Control Room                                       | 25        |
| 4-3 Stage Manager' s Console                           | 25        |
| 4-5 Communications                                     | 26        |
| 4-6 Locations of Communications                        | 27        |
| 4-7 Stage Cameras and Video Surveillance Systems       | 27        |
| 4-8 Paging Systems                                     | 27        |
| 4-9 Projector                                          | 29        |
| <b>5 Backstage</b>                                     | <b>30</b> |
| 5-1 Dressing Room and Green Room                       | 30        |
| 5-2 Orchestra Facilities                               | 30        |
| 5-3 Pianos (shared between four <i>venues</i> )        | 31        |
| 5-4 Pipe Organ                                         | 32        |
| 5-5 Loading Dock/ Scenery Shipping Path / Loading Flow | 33        |
| 5-6 Other Facilities                                   | 35        |

Last updated:2025/1/25

# 1 General Information

## 1-1 National Kaohsiung Center for the Arts (WEIWUYING)

CENTER FOR THE ARTS, ARTS FOR THE PEOPLE, National Kaohsiung Center for the Arts will become one of the important theatre complexes of the international art field. It includes four performance blocks, the 2,236 seat Opera House, the 1981 seat Concert Hall, the 1210 seat Play House and the 434 seat Recital Hall.



## 1-2 Concert Hall

The Concert Hall features a unique vineyard style. The unique design allows audience at various heights to enjoy the same optimal acoustic and visual effects, taking care of each and every member in the audience. The seating arrangement encircles the stage, bringing the audience closer to the stage for more intimate experiences with conductors and performers.



### 1-3 Traffic Information

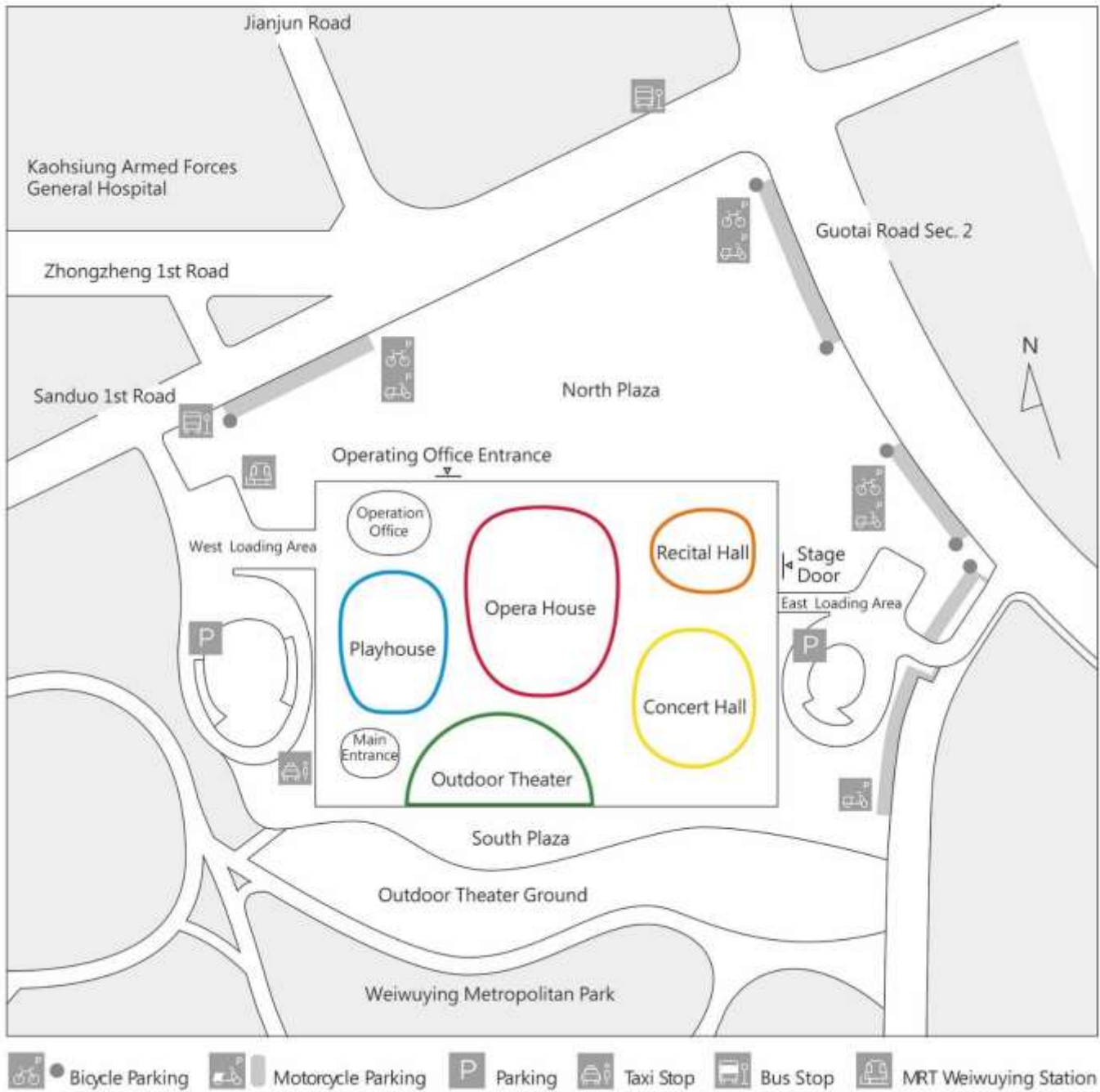

### 1-4 Contact Information

#### National Kaohsiung Center for the Arts (Weiwuying)

No.1, Sanduo 1st Rd., Fengshan Dist., Kaohsiung City 83075, Taiwan

+886 7-262-6666

service@npac-weiwuying.org

### 1-5 Stage door

Ground floor access is from the north and east side of building. Enter from Operating office entrance on Sanduo 1st Road or Stage Door on Guotai Road.

Basement Level 1 access is from Sanduo 1st Road entrance for Opera House and Playhouse, Guotai Road entrance for Concert Hall and Recital Hall.

Working pass will be required for entry.

### 1-6 Auditorium / Seating

2025/1/25

Seating Capacity : 1981 seats

- House Seats : 1662 seats (1F/253 seats 、 2F/858 seats 、 3F/551 seats)
- Wheelchairs Seats : 14 seats
- Companion Seats : 14 seats
- Choir Seats : 185 seats(include Wheelchairs 6 seats 、 Companion 6 seats)
- Control Area Seats : 27 seats
- Reserved Seats for FOH : 8 seats
- Obstructed View Seats : 71 seats(Non-ticketing)
- Partial View

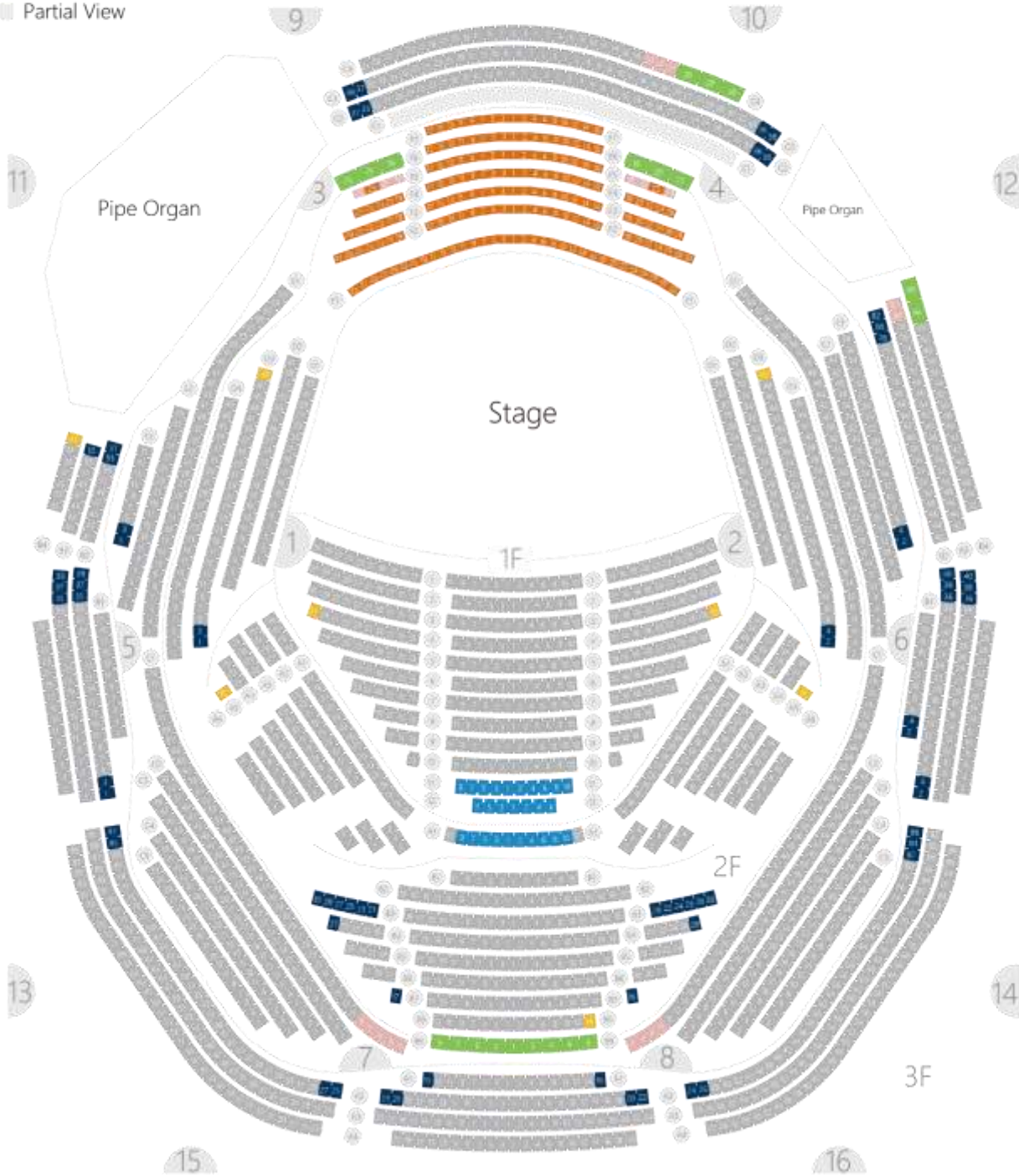

Figure 1.1- Concert Hall Seating plan

Set Up Equipment Recommended Seat

| Set Up Equipment Seat                                                  | Reserved Seat                                                                           | Notes                                                                                      |
|------------------------------------------------------------------------|-----------------------------------------------------------------------------------------|--------------------------------------------------------------------------------------------|
| 1st Floor 12 Row Seat 1                                                | 1st Floor 11 Row Seat 1、2、3<br>1st Floor 12 Row Seat 2、3<br>2nd Floor A1 Row Seat 1、2、3 | For Photo Shooting & Video Shooting                                                        |
| 2nd Floor B8 Row Seat 2                                                | 2nd Floor B7 Row Seat 1、2、4<br>2nd Floor B8 Row Seat 1、4                                | For Video Shooting                                                                         |
| 2nd Floor A1 Row Seat 49                                               | 2nd Floor A1 Row Seat 47<br>2nd Floor A2 Row Seat 31、33                                 | For Photo Shooting & Video Shooting                                                        |
| 2nd Floor A1 Row Seat 50                                               | 2nd Floor A1 Row Seat 48<br>2nd Floor A2 Row Seat 32、34                                 | For Photo Shooting & Video Shooting                                                        |
| 2nd Floor F1 Row Seat 1                                                | 2nd Floor F1 Row Seat 2、3<br>2nd Floor F2 Row Seat 1、3、5                                | For Video Shooting<br>* Videocassette recorders during non-ticketed hours for chorus only. |
| 2nd Floor F1 Row Seat 32                                               | 2nd Floor F1 Row Seat 30<br>2nd Floor F2 Row Seat 28、30                                 | For Photo Shooting & Video Shooting                                                        |
| 2nd Floor F1 Row Seat 33                                               | 2nd Floor F1 Row Seat 31<br>2nd Floor F2 Row Seat 29、31                                 | For Photo Shooting & Video Shooting                                                        |
| Set Up Control Area Seat                                               | Reserved Seat                                                                           | Notes                                                                                      |
| 1st Floor 11 Row Seat 1~10<br>1st Floor 12 Row Seat 1~7                | 2nd Floor A1 Row Seat 1~10                                                              |                                                                                            |
| 2nd Floor B7 Row Seat 1、3、5、2、4、6<br>2nd Floor B8 Row Seat 1、3、5、2、4、6 | 2nd Floor B7 Row Seat 7、8<br>2nd Floor B8 Row Seat 7、8                                  | The height of the device should be such that it does not block the rear wheelchair seat.   |
| 2nd Floor D2 Row Seat 38、40、42                                         | 2nd Floor D1 Row Seat 32、34<br>2nd Floor D2 Row Seat 24、26、28、30、32、34、36               | Laser Projector/ Downlight type<br>Captioner Operator Location.                            |

1-7 Concert Hall Plan

# 音樂廳一樓化妝室位置圖

## Concert Hall 1F Dressing Room Map



- 1235 團體辦公室  
Company Office
- 1245 化妝室 - 01  
Dressing Room - 01
- 1248 化妝室 - 02  
Dressing Room - 02
- 1250 化妝室 - 03  
Dressing Room - 03
- 1252 化妝室 - 04  
Dressing Room - 04
- 1254 休息準備室  
Green Room

|                                                                                                     |                                                                                                            |                                                                                                      |                                                                                                      |                                                                                                                    |
|-----------------------------------------------------------------------------------------------------|------------------------------------------------------------------------------------------------------------|------------------------------------------------------------------------------------------------------|------------------------------------------------------------------------------------------------------|--------------------------------------------------------------------------------------------------------------------|
|  出入口<br>Entrance |  飲水機<br>Water Dispenser |  醫護室<br>Infirmary |  洗手間<br>Restroom |  樓梯 / 電梯<br>Stairs / Elevator |
|-----------------------------------------------------------------------------------------------------|------------------------------------------------------------------------------------------------------------|------------------------------------------------------------------------------------------------------|------------------------------------------------------------------------------------------------------|--------------------------------------------------------------------------------------------------------------------|

Figure 1.3- Concert Hall 1F plan

# 音樂廳地下一樓化妝室位置圖

## Concert Hall B1F Dressing Room Map

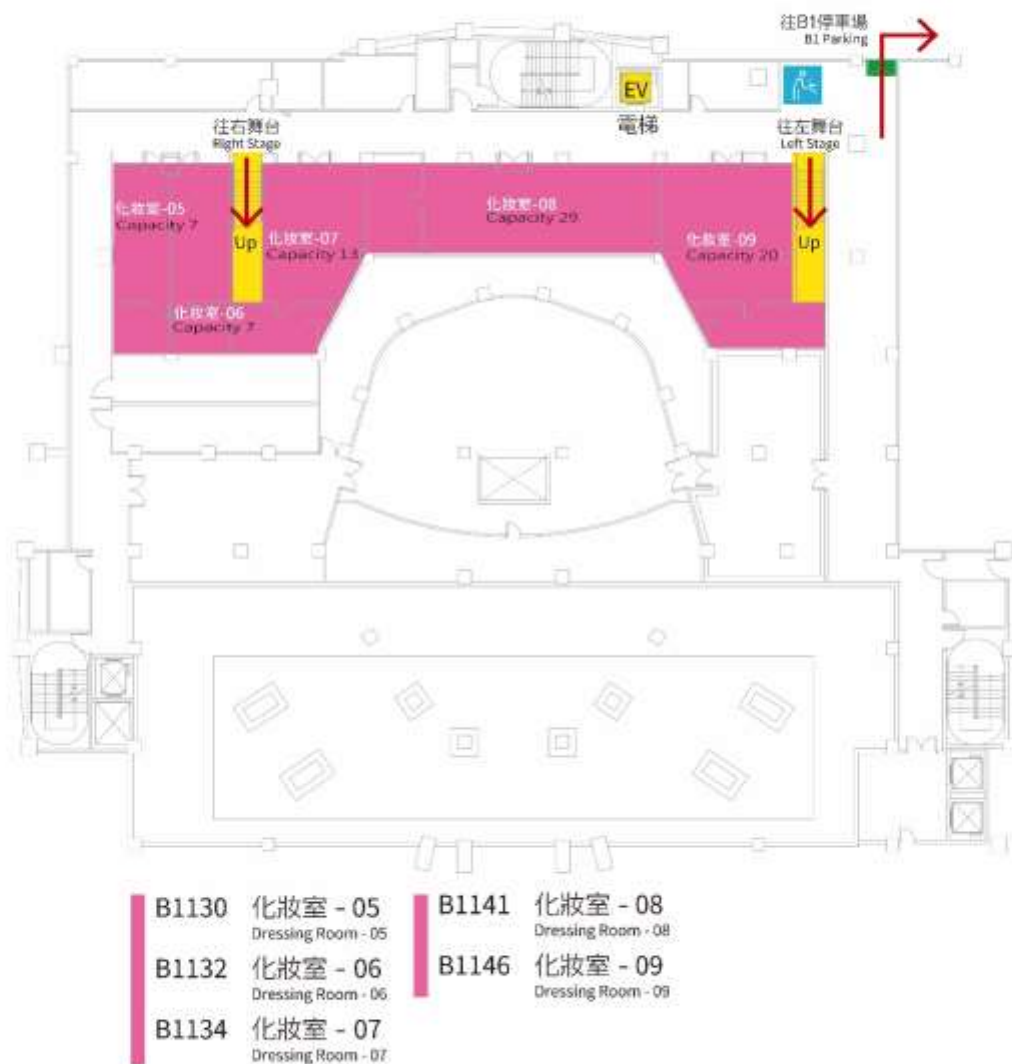

Figure 1.4- Concert Hall B1F plan



1-8 Concert Hall Section

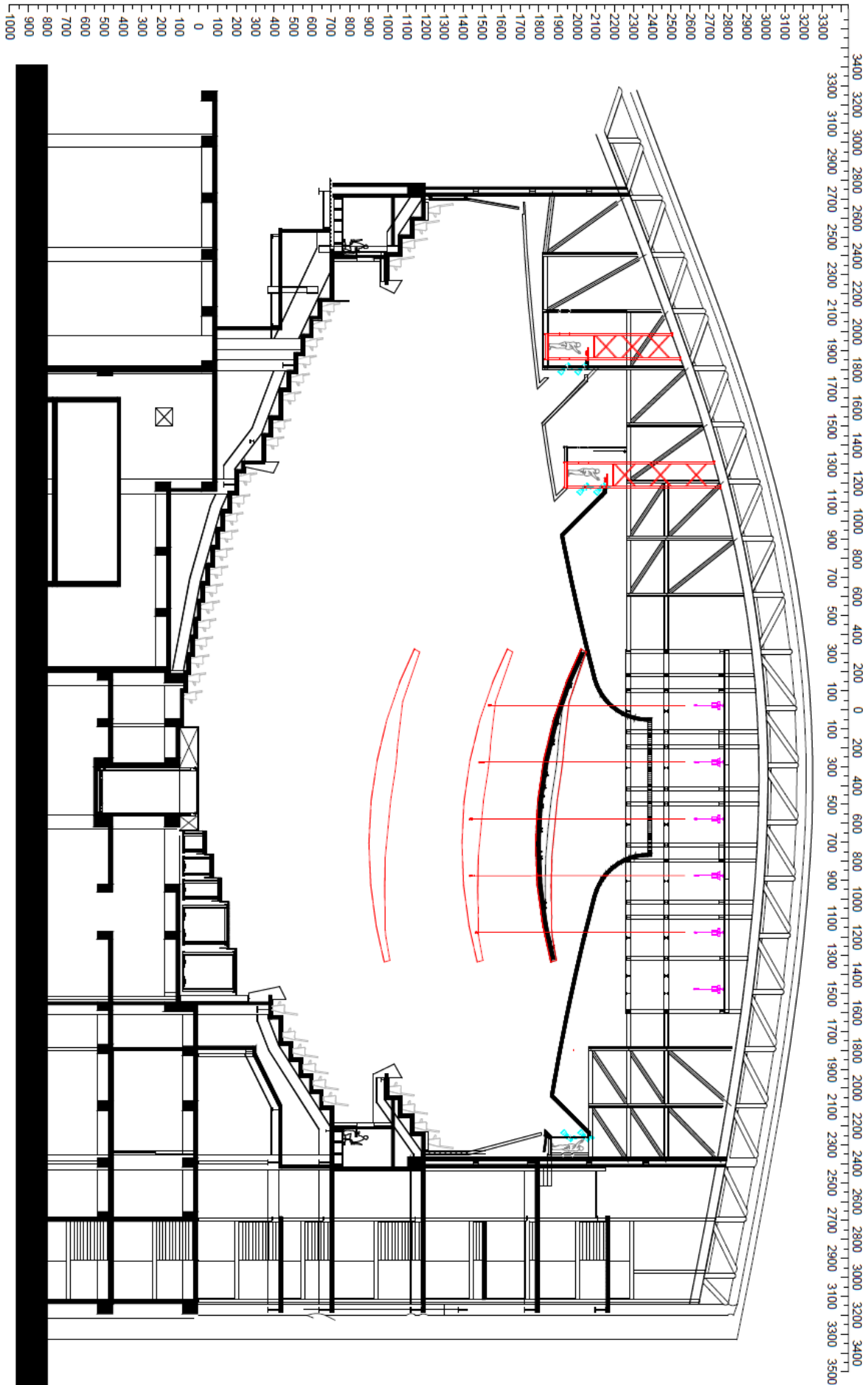

Figure 1.5- Concert Hall Section

## 2 Stage

### 2-1 Stage

20.8m (Width) x 13.6m (depth) x 0.8m (height from auditorium floor to stage level)  
 The stage area is 223.9 m<sup>2</sup>

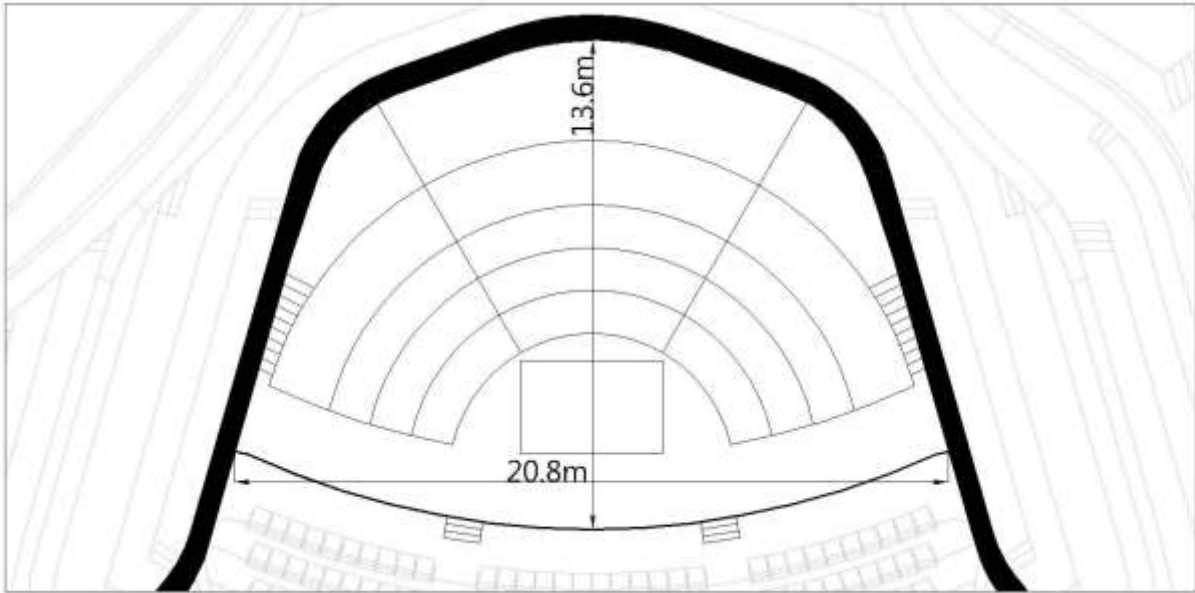

Figure 2.1-Stage Plan

### 2-2 Hoisting

#### 2-2-1 Chain hoist (load 1000kg, fixed speed: 9.6m/min)

Above Stage, 24 sets, operation length 30m, Movecat chain hoist  
 Hoist can be connected to the main controller from both sides of the stage.  
 \*The Chain hoist No.21 currently suspended.

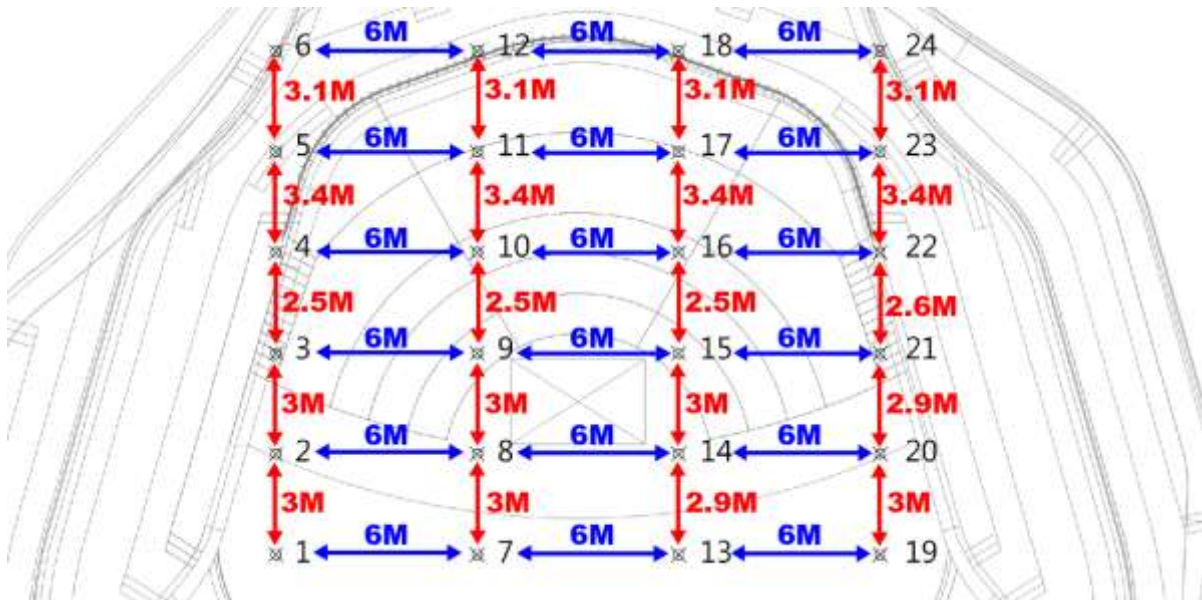

Figure 2.2 - Stage Hoisting plan

#### 2-2-2 Trusses

| Item                     | Quantity | Dimension                                                             | Paid Item |
|--------------------------|----------|-----------------------------------------------------------------------|-----------|
| EUOTRUSS HD33 (Triangle) | 27       | 0.29m( equilateral triangle length ) x 0.25m(Height) x 4 m( length )  | *         |
|                          | 4        | 0.29m( equilateral triangle length ) x 0.25m( Height) x 3 m( length ) | *         |

Items with \* mark are paid items. Please refer to the rate tables of National Kaohsiung Center for the Arts.

\*Labor for disassembly and assembly not included.

### 2-3 Stage Elevation Platform

Stage elevation platform consists of a center stage and five rows of platforms (15 arc platforms). Platforms can be adjusted for different orchestral formations and performance.

The marked lengths and widths below are the maximums; the actual area are shown in square meters.

| Position     | Platform number | Dimension(Length x Width , Area )       | Platform elevation height limit (from stage level) |
|--------------|-----------------|-----------------------------------------|----------------------------------------------------|
| Row 1        | No.1- No.3      | 1.2m x 4.73m, 5 m <sup>2</sup>          | 40cm                                               |
| Row 2        | No.4- No.6      | 1.2m x 5.93m, 6 m <sup>2</sup>          | 80cm                                               |
| Row 3        | No.7- No.9      | 1.2m x 7.13m, 8 m <sup>2</sup>          | 120cm                                              |
| Row 4        | No.10 - No.12   | 2.4m x 9.53m, 21 m <sup>2</sup>         | 160cm                                              |
| Row 5        | No.13 / No.15   | 4.65m x 1.0m/2.8m, 9 m <sup>2</sup>     | 200cm                                              |
|              | No.14           | 2.7m x 9.53m/12.1m, 28.5 m <sup>2</sup> |                                                    |
| Center Stage |                 | 3.8m x 2.4m, 9.12 m <sup>2</sup>        | -45cm                                              |

Capacity: Static: 500kg/ m<sup>2</sup>  
Dynamic : 250kg/ m<sup>2</sup>

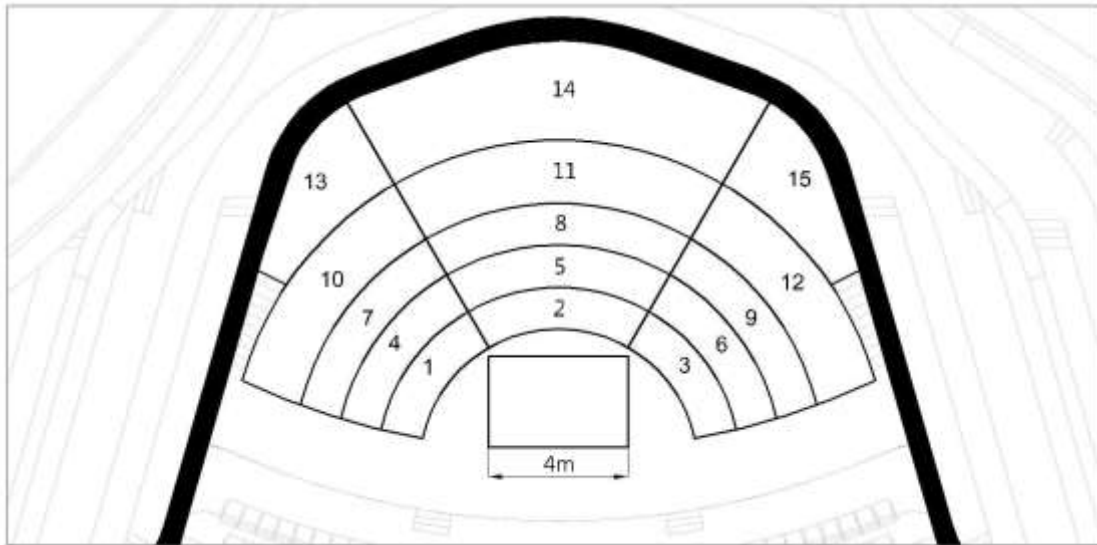

Figure 2.3 - Stage Elevation Platform plan

### 2-4 Acoustic Panel

The acoustic panel is placed above the stage, with the size of 16m in length, 16.6m in width and the total area of 200 m<sup>2</sup>. Elevation starts from 0.05m to 17.8m. The set heights are 9m, 14m and 17.8m. Equipped with 67 sets of ETC S4 PAR

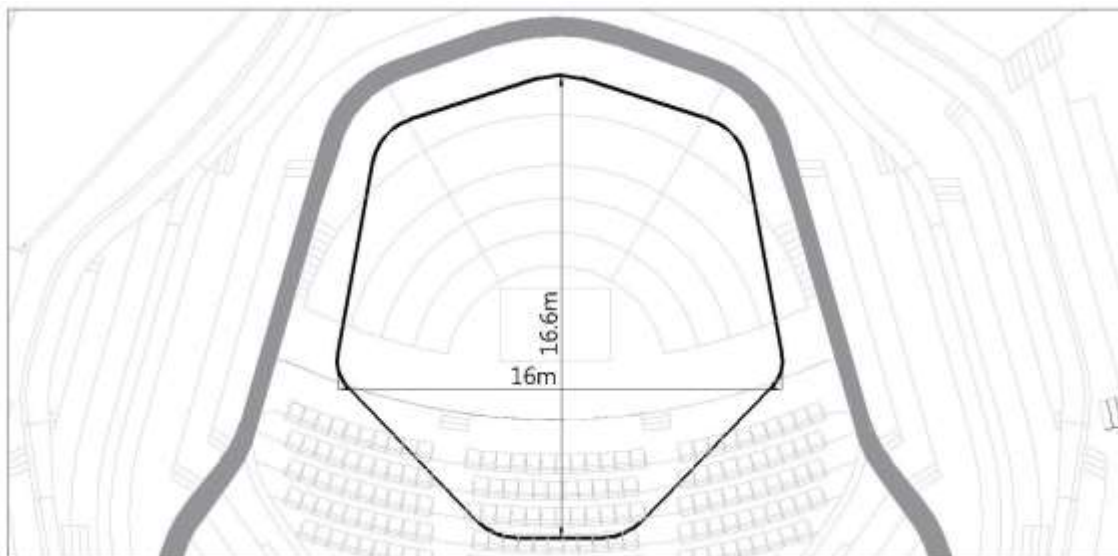

Figure 2.4- Acoustic Panel Plan

### 3 Lighting

#### 3-1 Lighting System

The basic lighting for stage area is fixedly built in the Acoustic Panel, also provide 9 openable catwalk openings, which can be opened individually by the lighting requirements of the show.

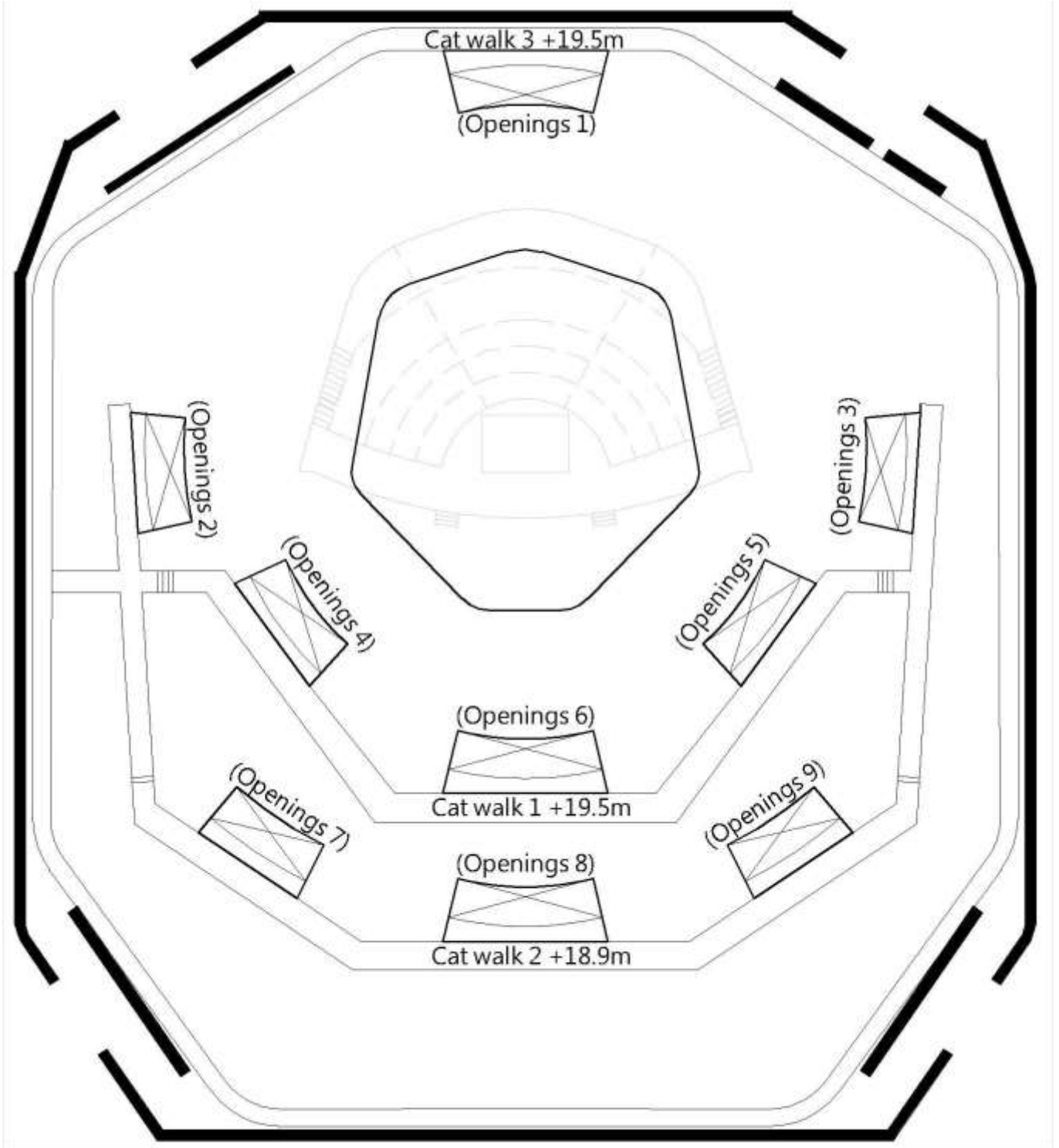



Figure 3.1 - Lighting Openings Position Plan

### 3-2 Lighting Instrument

| Item                                         | Position                      | Model                                   | Specifications             | Quantity       | Frame Size  | Note          | Paid Item   |  |
|----------------------------------------------|-------------------------------|-----------------------------------------|----------------------------|----------------|-------------|---------------|-------------|--|
| Lighting Console                             | Master Control Booth          | GrandMA 2 Ultra Light                   |                            | 1              |             |               |             |  |
|                                              | Sub Master Control Booth      |                                         |                            | 1              |             |               |             |  |
| Dimmer System                                | Dimmer Room                   | State Automation Solution               | 220V<br>3kW/Circuit        | 256ch          |             |               |             |  |
| Ellipsoidal Reflector Spotlight              | Openings 1                    | Prolights EclProfile FW 14°             | 110-240V<br>/270W          | 12             | 16.9x16.9cm |               |             |  |
|                                              |                               | Prolights EclProfile FW 19°             |                            | 2              | 15.9x15.9cm |               |             |  |
|                                              | Openings 2                    | Prolights EclProfile FW 14°             |                            | 8              | 16.9x16.9cm |               |             |  |
|                                              |                               | Prolights EclProfile FW 19°             |                            | 2              | 15.9x15.9cm |               |             |  |
|                                              | Openings 3                    | Prolights EclProfile FW 14°             |                            | 8              | 16.9x16.9cm |               |             |  |
|                                              |                               | Prolights EclProfile FW 19°             |                            | 2              | 15.9x15.9cm |               |             |  |
|                                              | Openings 4                    | Prolights EclProfile FW 19°             |                            | 1              | 15.9x15.9cm |               |             |  |
|                                              |                               | Prolights EclProfile FW 26°             |                            | 1              |             |               |             |  |
|                                              |                               | Prolights EclProfile FW 36°             |                            | 1              |             |               |             |  |
|                                              | Openings 5                    | Prolights EclProfile FW 19°             |                            | 1              | 15.9x15.9cm |               |             |  |
|                                              |                               | Prolights EclProfile FW 26°             |                            | 1              |             |               |             |  |
|                                              |                               | Prolights EclProfile FW 36°             |                            | 1              |             |               |             |  |
|                                              | Openings 6                    | Prolights EclProfile FW 10°             |                            | 2              | 30.5x30.5cm |               |             |  |
|                                              |                               | Prolights EclProfile FW 14°             |                            | 12             | 16.9x16.9cm |               |             |  |
|                                              | Openings 7                    | Prolights EclProfile FW 10°             |                            | 10             | 30.5x30.5cm |               |             |  |
|                                              | Openings 8                    | Prolights EclProfile FW 10°             |                            | 12             | 30.5x30.5cm |               |             |  |
|                                              |                               | Prolights EclProfile FW 19°             |                            | 4              | 15.9x15.9cm |               |             |  |
|                                              | Openings 9                    | Prolights EclProfile FW 10°             |                            | 10             | 30.5x30.5cm |               |             |  |
|                                              | Stage Fixed at Acoustic Panel | Ovation P-56WW                          |                            | 220V/230W      | 67          | 19.1x19.1cm   |             |  |
|                                              | 2KW Fresnel Spotlight 8"      | Storage                                 |                            | Selecon SPX 5° | 220V/800W   | 10            | 24.5x24.5cm |  |
| Selecon SPX 14°                              |                               |                                         | 1                          | 15.8x15.8cm    |             |               |             |  |
| Selecon SPX 19°                              |                               |                                         | 12                         |                |             |               |             |  |
| Parabolic Aluminized Reflector Spotlight     |                               | Selecon Arena Theatre 8" Fresnel 7°-60° | 220V/2kW                   | 30             | 24.5x24.5cm |               |             |  |
|                                              |                               | PAR 64-Kupo PL-64LB                     | 220V/1kW                   | 48             | 25.4x25.4cm | Lamp : M x 48 |             |  |
| Long Throw Follow Spot                       | Openings 7<br>Openings 9      | Robin BMFL<br>Followspot LT             | 220V/1.7Kw                 | 2              |             |               |             |  |
| LED Colorpanel RGBW<br>*Used for Organ only. | For Organ                     | Stagehero S400 Color Panel-C4           | 110-220V/<br>4A-2A<br>440W | 1 Set          |             |               | *           |  |
| Follow Spot Operator                         |                               |                                         | Operator/<br>4 Hour        | 1              |             |               | *           |  |

Items with \* mark are paid items. Please refer to the rate tables of National Kaohsiung Center for the Arts.

### 3-3 Accessories

| Item                   | Specifications                                                                                                 | Size   | Quantity |
|------------------------|----------------------------------------------------------------------------------------------------------------|--------|----------|
| Barn Door              | 2kW Fresnel                                                                                                    |        | 6        |
| Iris                   | For Selecon Ellipsoidal Reflector Spotlight                                                                    |        | 16       |
| Gobo Holder            | For Selecon Ellipsoidal Reflector Spotlight                                                                    | B Size | 40       |
| Power Distribution Box | 8CIR CEE Form Female Plug<br> |        | 15       |
| Multi-Cable            | 16pin Multi-Cable Harting Connector                                                                            | 5m     | 13       |
|                        |                                                                                                                | 10m    | 3        |
|                        |                                                                                                                | 15m    | 3        |
| Ex-Cable               | CEE16A                                                                                                         | 1.5m   | 19       |
|                        |                                                                                                                | 2m     | 30       |
|                        |                                                                                                                | 3m     | 17       |
|                        |                                                                                                                | 5m     | 9        |
|                        |                                                                                                                | 10m    | 6        |
|                        |                                                                                                                | 15m    | 6        |
| Adapter Cable          | CEE 16A(M) To Stage-Pin(F)                                                                                     |        | 20       |

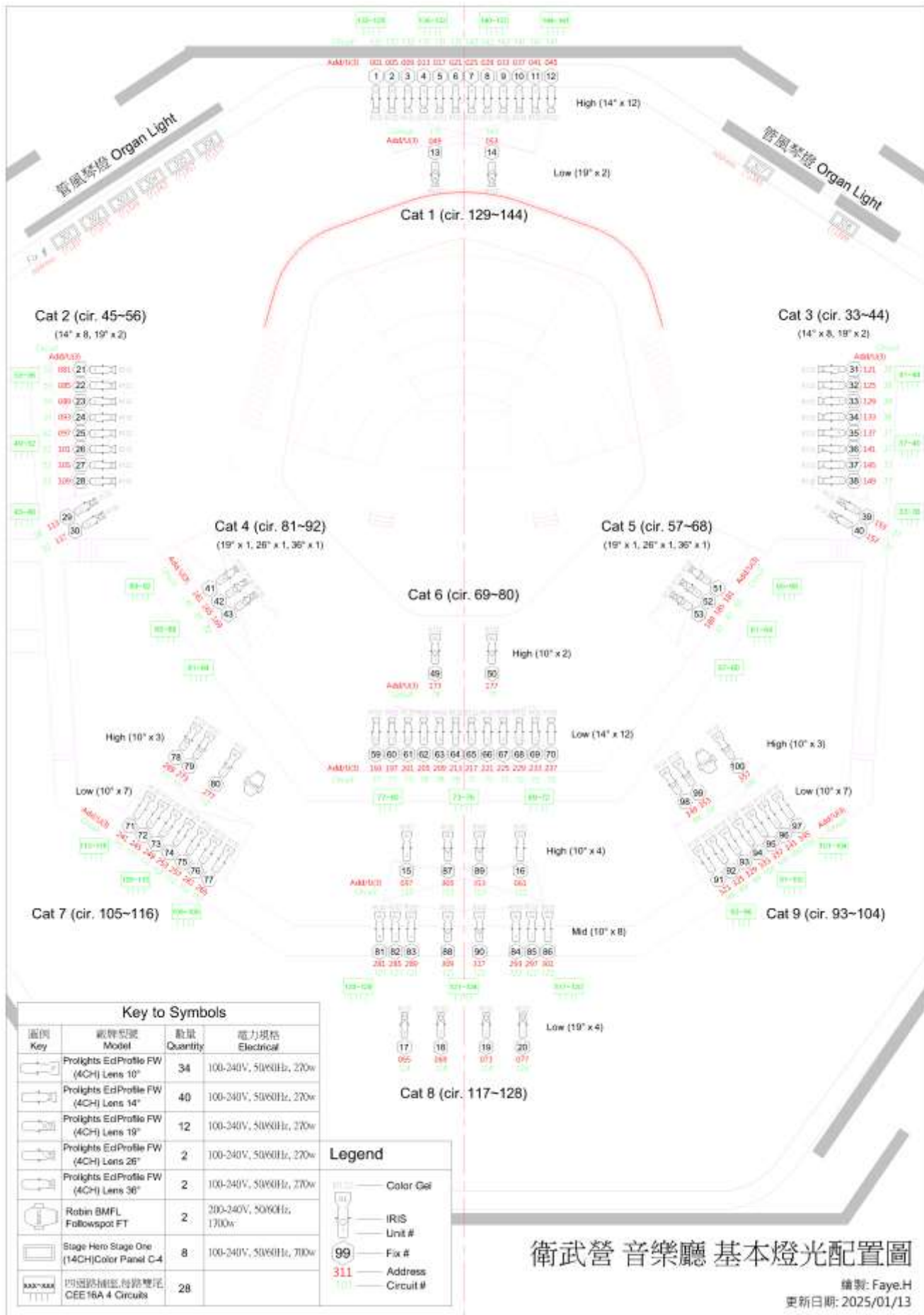

Figure 3.3.1- FOH Lighting Plot

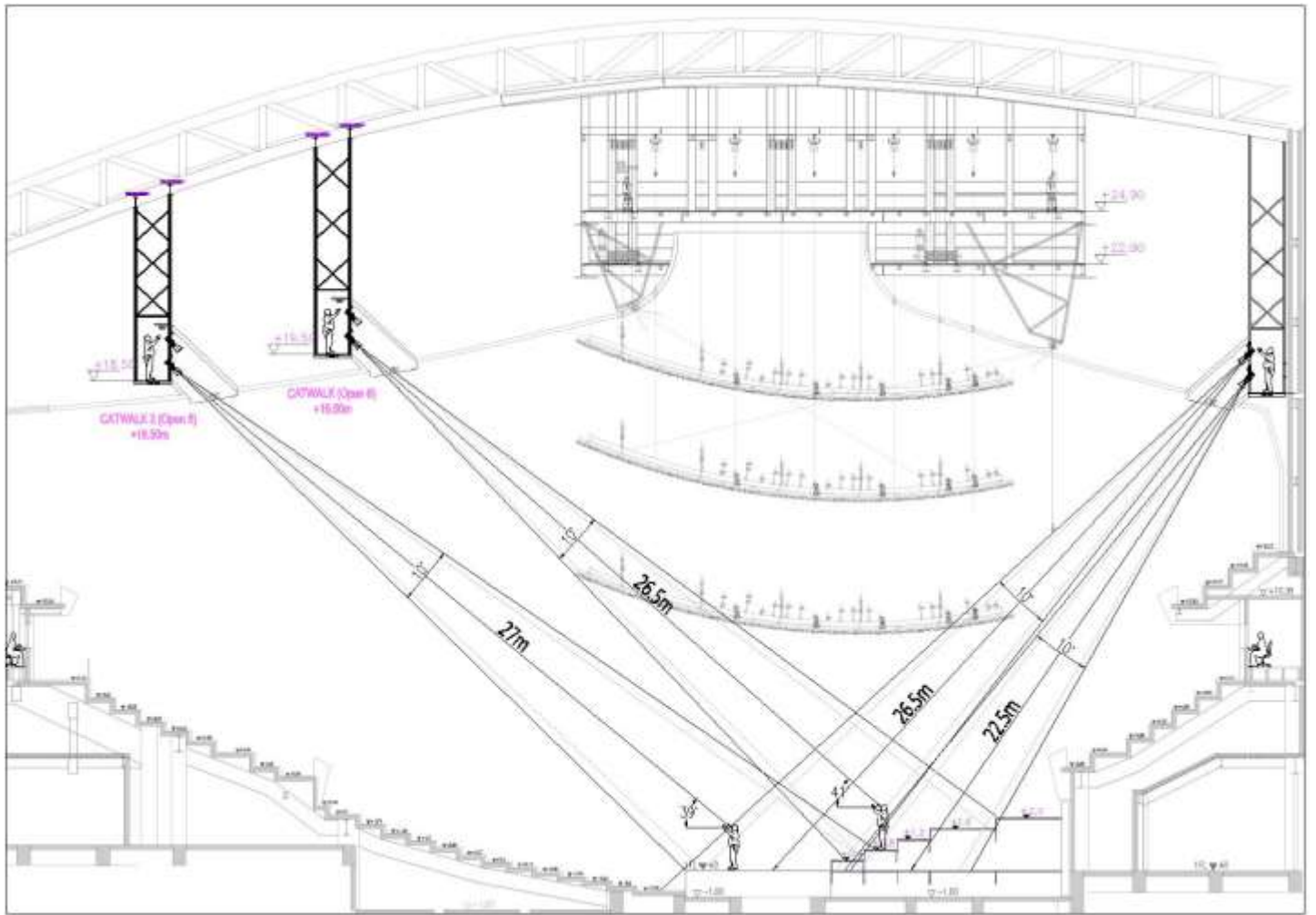

Figure 3.3.2- Lighting Section



### 3-4 Lighting DMX system

\*Please patch all additional fixtures from (5)001,thanks.

| Item     | Position           | Model                  | Quantity | Note                                   | Paid Item |
|----------|--------------------|------------------------|----------|----------------------------------------|-----------|
| Node     | Grid               | MA3 4Port              | 1        |                                        |           |
|          | Off Left/Off Right | MA2 2Port              | 1/1      |                                        |           |
|          | DL Stage/DR Stage  |                        | 1/1      |                                        |           |
|          | Portable           | MA3 2Port              | 2        |                                        |           |
| Isolator | Grid               | Chauvet RDMX Splitter8 | 2        | All isolators are 2 in 4 out (default) |           |

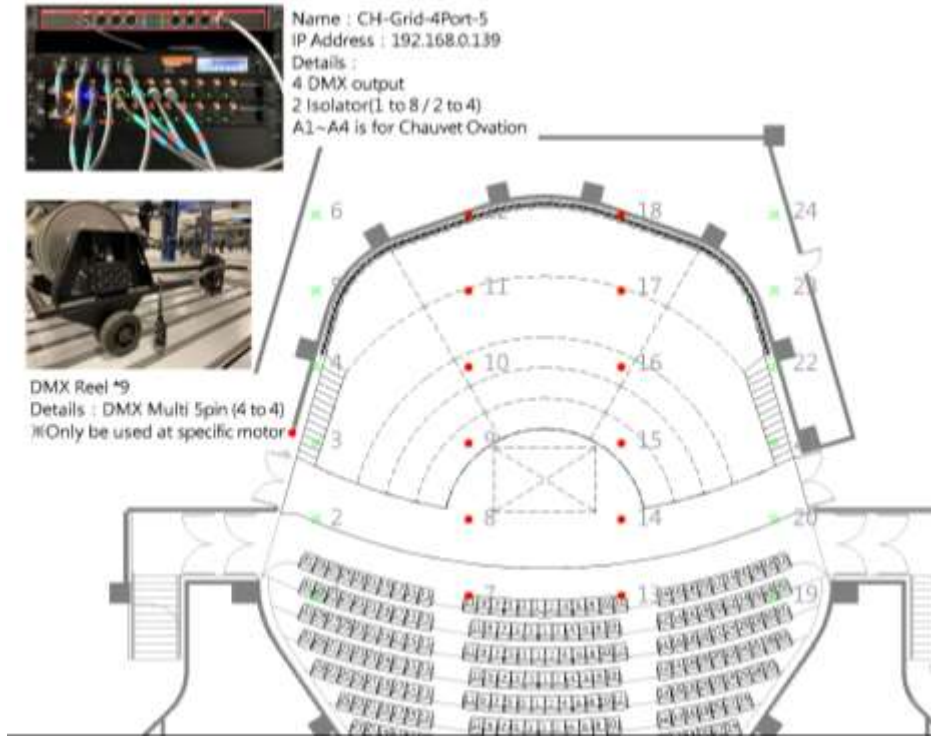

Figure 3.4.1- Grid Area Node Position Layout

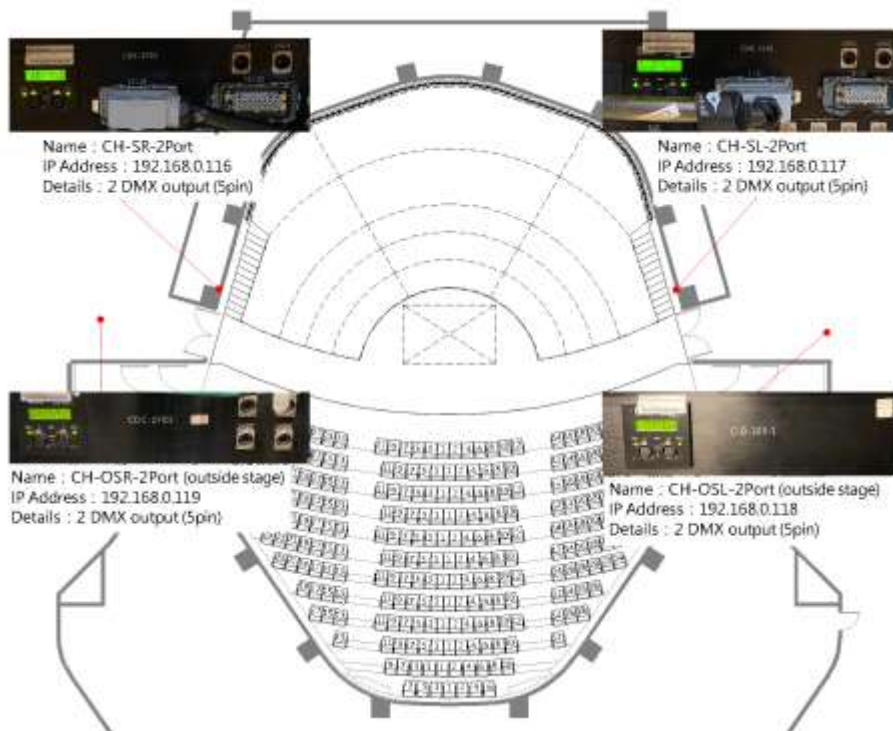

Figure 3.4.2- Stage Area Node Position Layout

### 3-5 Lighting Circuit

#### 3-5-1 Stage area

| Area and Position        | Connector           | Dimmer Circuit No. | Load | Network Circuit No. |
|--------------------------|---------------------|--------------------|------|---------------------|
| Down Stage/L             | Harting(8 circuits) | 001 ~ 008          | 3kW  | LN01~LN02           |
|                          |                     | 009 ~ 016          |      |                     |
| Down Stage/R             | Harting(8 circuits) | 017 ~ 024          | 3kW  | LN03~LN04           |
|                          |                     | 025 ~ 032          |      |                     |
| Stage Right Waiting Area |                     |                    |      | LN05~LN08           |
| Under Auditorium 12 rows |                     |                    |      | LN09~LN16           |

**Ca = CEE 16A**  
**Cb = CEE 32A**  
**H = Harting(8 Circuits)**

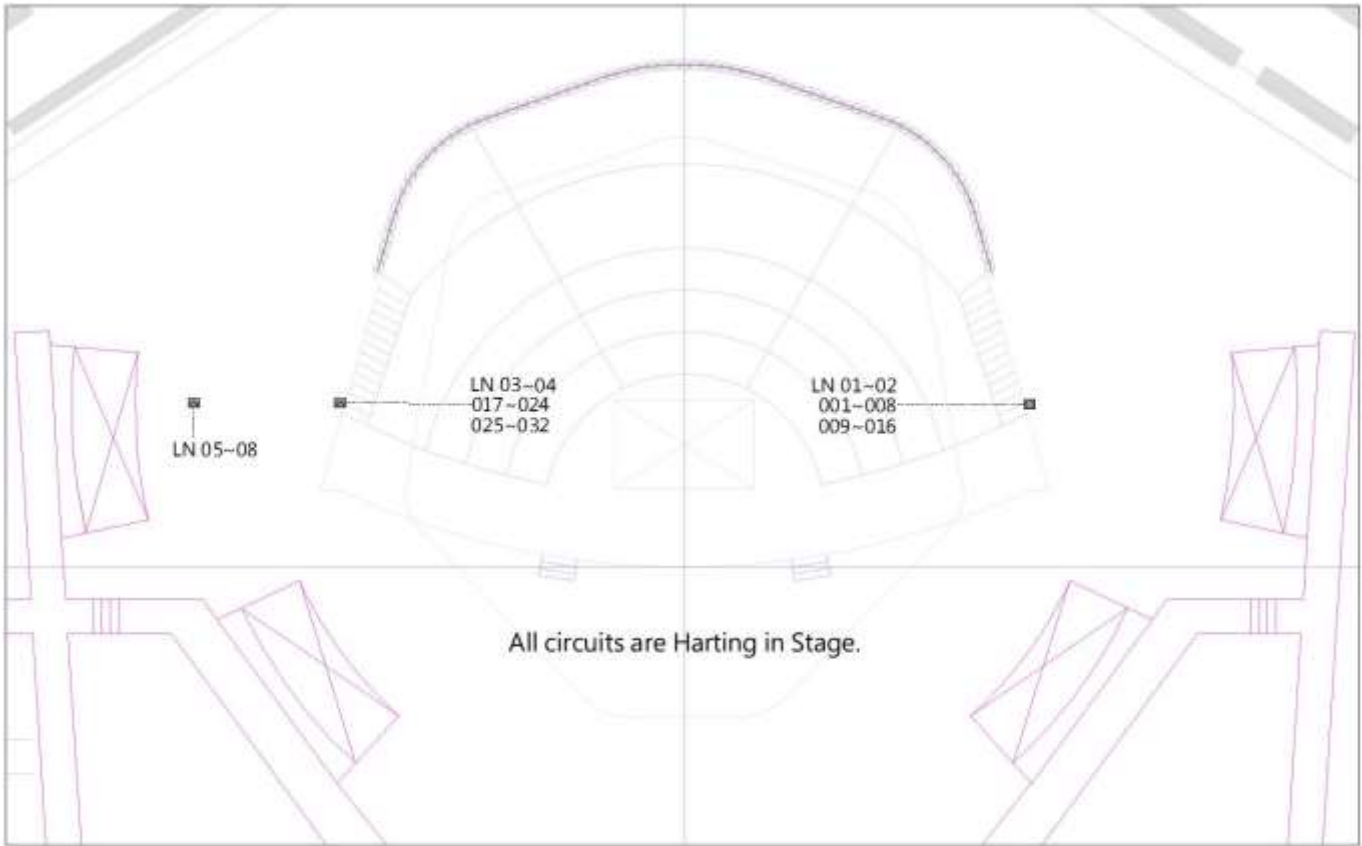

Figure 3.5.1.1- Stage Area Lighting Circuit Layout

3-5-2 Front of House

| Area and Position        |                              | Connector                      | Dimmer Circuit No. | Load | Network Circuit No. |
|--------------------------|------------------------------|--------------------------------|--------------------|------|---------------------|
| Master Control Booth     |                              |                                |                    |      | LN21~ LN24          |
| Sub Master Control Booth |                              |                                |                    |      | LN25~LN32           |
| Openings 1               | 3 rd. Catwalk<br>-Rear Stage | CEE 16A<br>(2 outputs/circuit) | 129 ~ 132          | 3kW  | LN53~LN54           |
|                          |                              |                                | 133 ~ 136          |      |                     |
|                          |                              |                                | 137 ~ 140          |      |                     |
|                          |                              |                                | 141 ~ 144          |      |                     |
| Openings 2               | Lighting Box/R               | CEE 16A<br>(2 outputs/circuit) | 045 ~ 048          | 3kW  | LN39~LN40           |
|                          |                              |                                | 049 ~ 052          |      |                     |
|                          |                              |                                | 053 ~ 056          |      |                     |
| Openings 3               | Lighting Box/L               | CEE 16A<br>(2 outputs/circuit) | 033 ~ 036          | 3kW  | LN37~LN38           |
|                          |                              |                                | 037 ~ 040          |      |                     |
|                          |                              |                                | 041 ~ 044          |      |                     |
| Openings 4               | 1st. Catwalk-Stage/R         | CEE 16A<br>(2 outputs/circuit) | 081 ~ 084          | 3kW  | LN45~LN46           |
|                          |                              |                                | 085 ~ 088          |      |                     |
|                          |                              |                                | 089 ~ 092          |      |                     |
| Openings 5               | 1st. Catwalk-Stage/L         | CEE 16A<br>(2 outputs/circuit) | 057 ~ 060          | 3kW  | LN41~LN42           |
|                          |                              |                                | 061 ~ 064          |      |                     |
|                          |                              |                                | 065 ~ 068          |      |                     |
| Openings 6               | 1st. Catwalk -Center         | CEE 16A<br>(2 outputs/circuit) | 069 ~ 072          | 3kW  | LN43~LN44           |
|                          |                              |                                | 073 ~ 076          |      |                     |
|                          |                              |                                | 077 ~ 080          |      |                     |
| Openings 7               | 2nd. Catwalk- Stage/R        | CEE 16A<br>(2 outputs/circuit) | 105 ~ 108          | 3kW  | LN49~LN50           |
|                          |                              |                                | 109 ~ 112          |      |                     |
|                          |                              |                                | 113 ~ 116          |      |                     |
| Openings 8               | 2nd. Catwalk -Center         | CEE 16A<br>(2 outputs/circuit) | 117 ~ 120          | 3kW  | LN51~LN52           |
|                          |                              |                                | 121 ~ 124          |      |                     |
|                          |                              |                                | 125 ~ 128          |      |                     |
| Openings 9               | 2nd. Catwalk - Stage/L       | CEE 16A<br>(2 outputs/circuit) | 093 ~ 096          | 3kW  | LN47~LN48           |
|                          |                              |                                | 097 ~ 100          |      |                     |
|                          |                              |                                | 101 ~ 104          |      |                     |
| Acoustic Panel           | Grid-Up Stage                | Harting(8 circuits)            | 145 ~ 152          | 3kW  |                     |
|                          |                              |                                | 153 ~ 160          |      |                     |
| Stage Grid Area          | Grid-Up S.R.                 | Harting(8 circuits)            | 161 ~ 168          | 3kW  | LN55~LN56           |
|                          |                              |                                | 169 ~ 176          |      |                     |
|                          | Grid-Up S.L.                 |                                | 177 ~ 184          | 3kW  | LN57~LN58           |
|                          |                              |                                | 185 ~ 192          |      |                     |
|                          | Grid-Center S.R.             |                                | 193 ~ 200          | 3kW  | LN59~LN60           |
|                          |                              |                                | 201 ~ 208          |      |                     |
|                          | Grid- Center S.L.            |                                | 209 ~ 216          | 3kW  | LN61~LN62           |
|                          |                              |                                | 217 ~ 224          |      |                     |
|                          | Grid-Down S.R.               |                                | 225 ~ 232          | 3kW  | LN63~LN64           |
|                          |                              |                                | 233 ~ 240          |      |                     |
|                          | Grid- Down S.L.              |                                | 241 ~ 248          | 3kW  | LN65~LN66           |
|                          |                              |                                | 249 ~ 256          |      |                     |

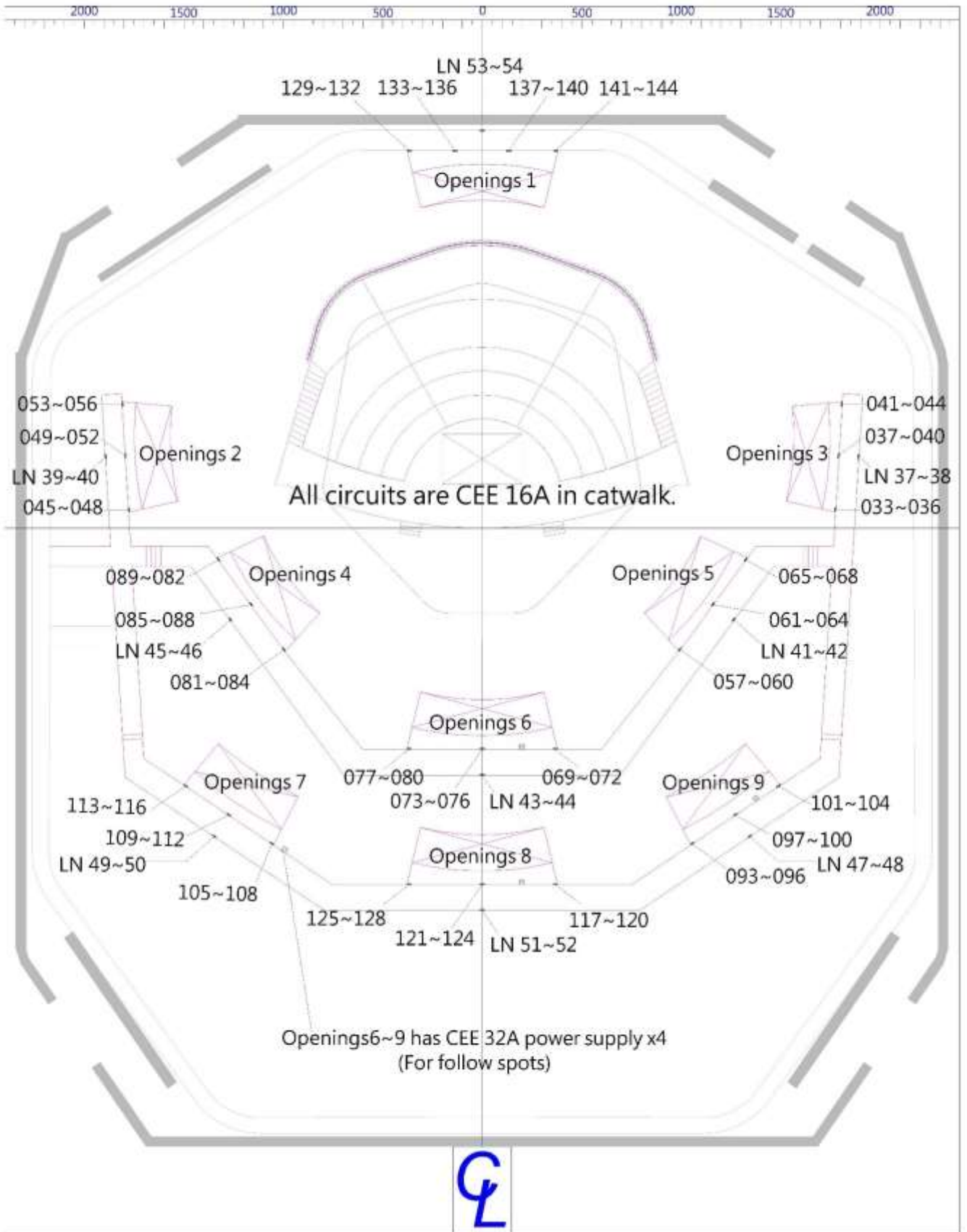

Figure 3.5.2.1- FOH Lighting Circuit Layout

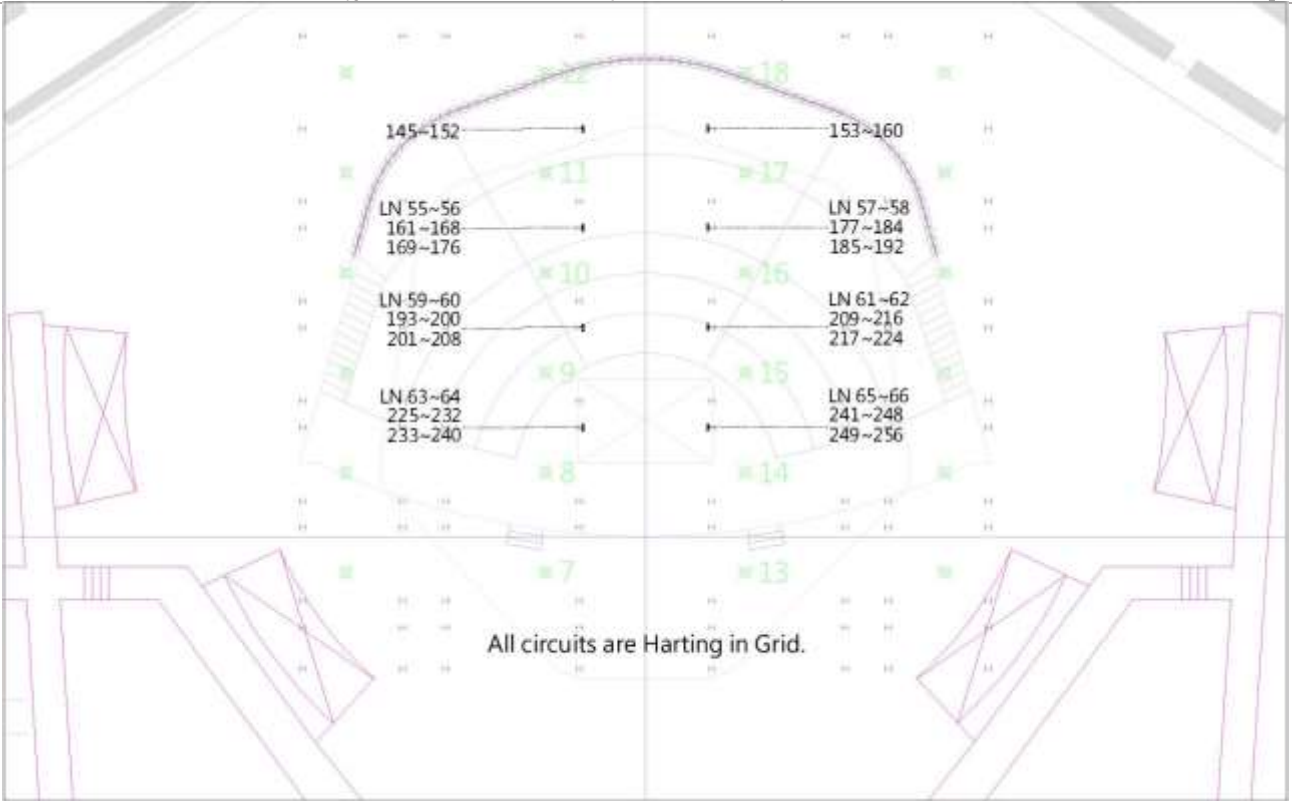

Figure 3.5.2- Grid Area Lighting Circuit Layout

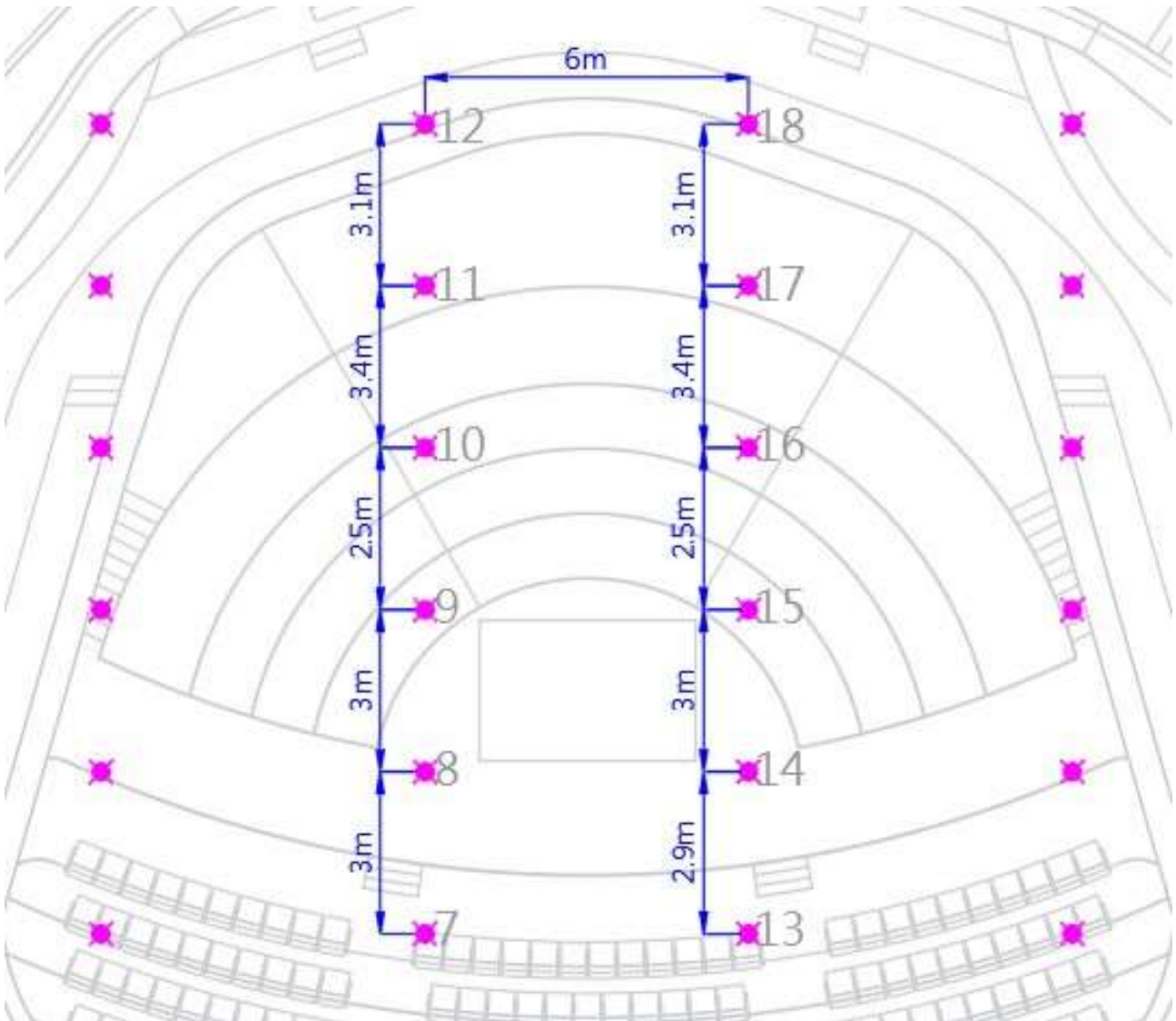

Figure 3.5.3- Chain hoist / Cable outlet

### 3-6 Portable Lift

Brand and Model : Snorkel UL-40 (Battery Power Supply)  
 Maximum height: 12.1m  
 Maximum weight: 136kg  
 Quantity: 1

### 3-7 Additional Power Supply

| Function | Position           | Specifications                                 | Quantity                              |
|----------|--------------------|------------------------------------------------|---------------------------------------|
| Stage    | Stage Left / Right | 3 $\phi$ 4W+G 380V/220V/60Hz (CEE 125A/3P+N+E) | 1/1                                   |
| Light    |                    | 3 $\phi$ 4W+G 208V/120V/60Hz (Camlock 250A)    | 1/1                                   |
| Sound    |                    | 3 $\phi$ 4W+G 208V/120V/60Hz (Camlock 50A)     | 1/1                                   |
|          |                    | Grid                                           | 3 $\phi$ 4W+G 208V/120V (Camlock 30A) |



Figure 3.7.1- Additional Power Supply

| Floor         | Position(Seat No.) | CEE32 220V   | CEE16 220V    | Edison connector 220V | Network Circuit No. |
|---------------|--------------------|--------------|---------------|-----------------------|---------------------|
| 2F-Chorus     | F1-30              | 1 output/30A | 1 output/15A  | 2 outputs/15A         | LN201               |
|               | F1-31              | 1 output/30A | 1 output/15A  | 2 outputs/15A         | LN202               |
| 3F-Pipe Organ | B2-82              |              | 2 outputs/15A | 2 outputs/15A         | LN303               |
|               | B2-57              |              | 2 outputs/15A | 2 outputs/15A         | LN304               |



Figure 3.7.2- CEE Connector Non-Dimmable Position Layout

### 3-8 Working Light / Auditorium Light

#### Working Light

Work lights provided white and blue light mode, and the control switch is located on the stage manager' s Desk.  
 Lighting area: Side stage entrance, Stage machine pit, Grid area and Cat walk.

#### Auditorium lights

Auditorium lights consists houselights and step lights, which can be separately controlled and dimmed. The control panel is located on the stage manager' s Desk and lighting control room.

## 4 Audio/Video Systems

### 4-1 Audio Facilities

| Item                      | Quantity | Brand and Model                                                                                                                                                                                       | Paid Item |
|---------------------------|----------|-------------------------------------------------------------------------------------------------------------------------------------------------------------------------------------------------------|-----------|
| Digital mixer             | 1        | Studer Vista 5 M3/32                                                                                                                                                                                  |           |
| Digital speaker           | 2        | Renkus-Heinz ICONYX IC24RII                                                                                                                                                                           |           |
| Digital speaker           | 2        | Renkus-Heinz ICONYX IC16RII                                                                                                                                                                           |           |
| Digital speaker           | 8        | Renkus-Heinz ICONYX IC8RII                                                                                                                                                                            |           |
| Stage front speaker       | 7        | Renkus-Heinz CFX41                                                                                                                                                                                    |           |
| 12" Stage Active speaker  | 8        | Renkus-Heinz PN121M/12                                                                                                                                                                                | *         |
| 6.5" Stage Active speaker | 8        | Renkus-Heinz PN61                                                                                                                                                                                     | *         |
| Digital I/O Fiber Module  | 2        | Studer D21M                                                                                                                                                                                           |           |
| Dual channel Equalizer    | 4        | BSS FCS 960                                                                                                                                                                                           | *         |
| Stereo audio converter    | 1        | Whirlwind PcUSB 2-Channel<br>USB Direct Box                                                                                                                                                           |           |
| Mixing console            | 1        | Midas M32R LIVE<br>Stage Box : Midas DL16                                                                                                                                                             | *         |
|                           |          |                                                                                                                                                                                                       | *         |
|                           |          |                                                                                                                                                                                                       | *         |
| Wireless PA equipment     | 2        | MIPRO MA-708                                                                                                                                                                                          | *         |
| Wireless PA equipment     | 2        | MIPRO MA-808                                                                                                                                                                                          | *         |
| Wireless PA equipment     | 2        | MIPRO MA-828                                                                                                                                                                                          | *         |
| Mixing console Combo      | 4        | Mixer : YAMAHA DM3 Standard<br>Handheld Wireless Microphone :<br>Mipro ACT-747 x 1 、 ACT-700H x 4<br>Speaker : Renkus-Heinz PN61 x 2<br>Including assembly and disassembly and<br>execution manpower. | *         |
| Mixing console            | 1        | Midas heritage D HD96-24-CC-TP<br>Stage Box : Midas DL231                                                                                                                                             |           |
| Signal Splitters          | 1        | Midas DL431                                                                                                                                                                                           |           |

Items with \* mark are paid items. Please refer to the rate tables of National Kaohsiung Center for the Arts.

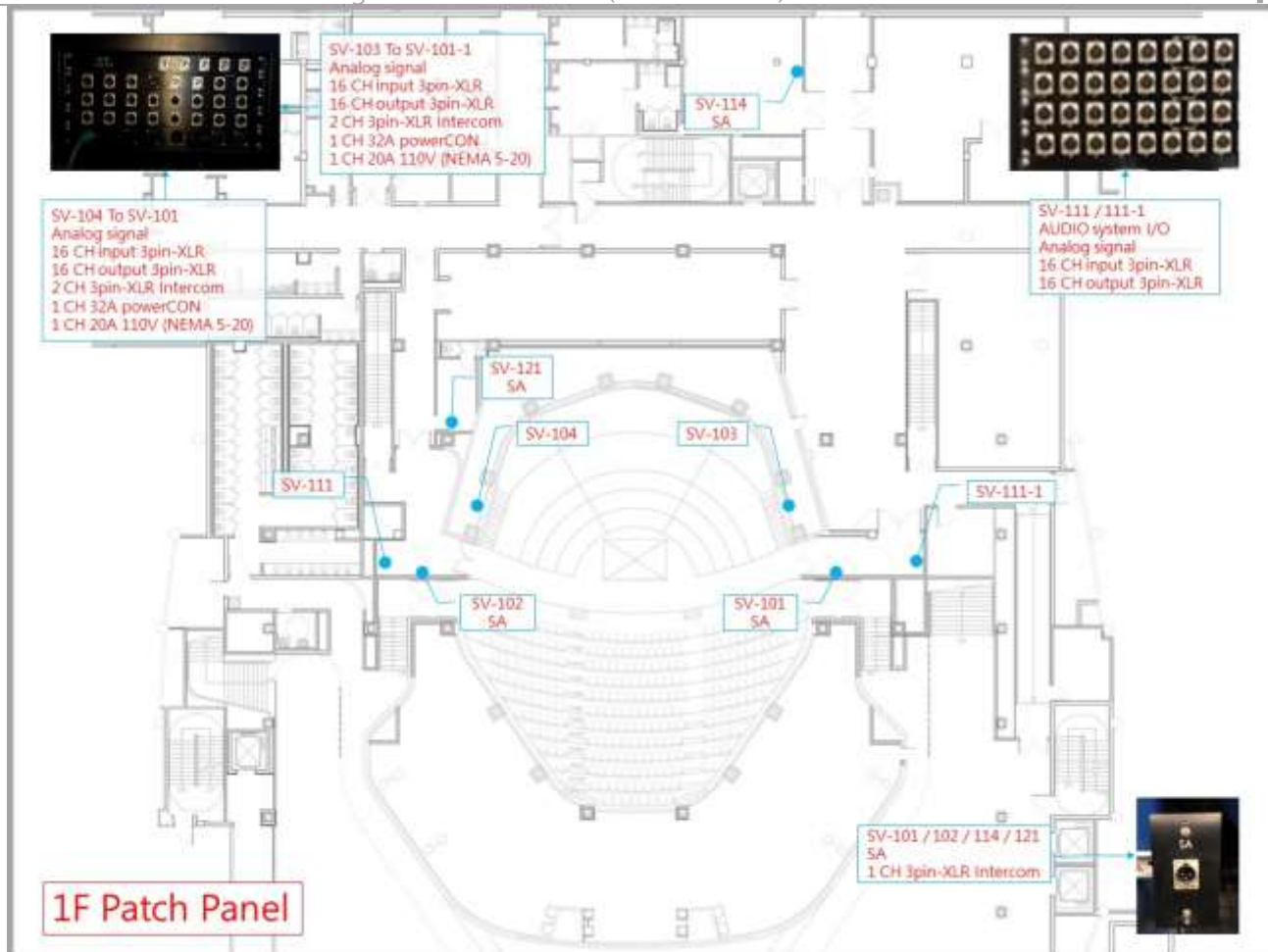

Figure 4-1.1- 1F Audio system channel diagram

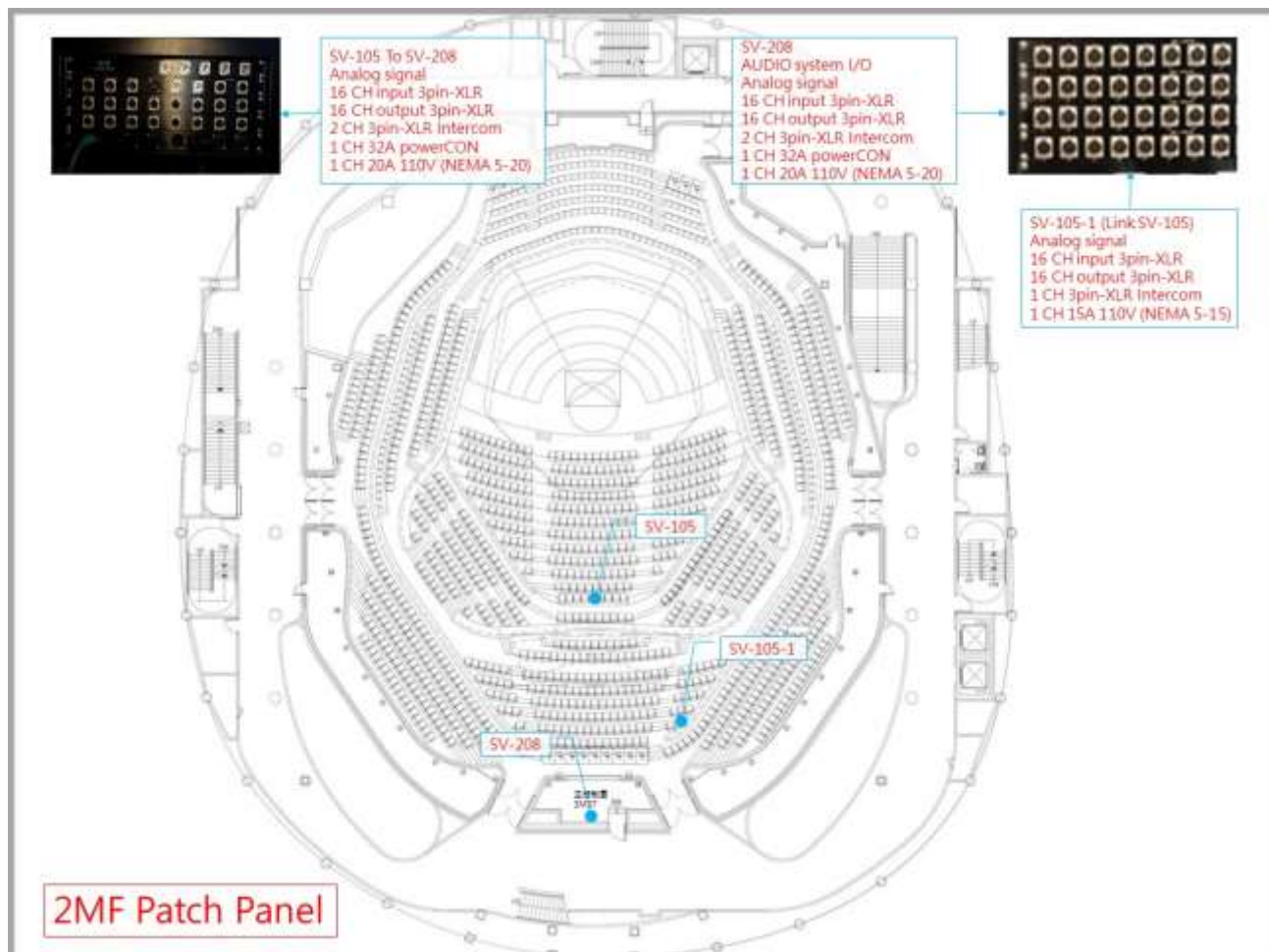

Figure 4-1.2 2MF Audio system channel diagram



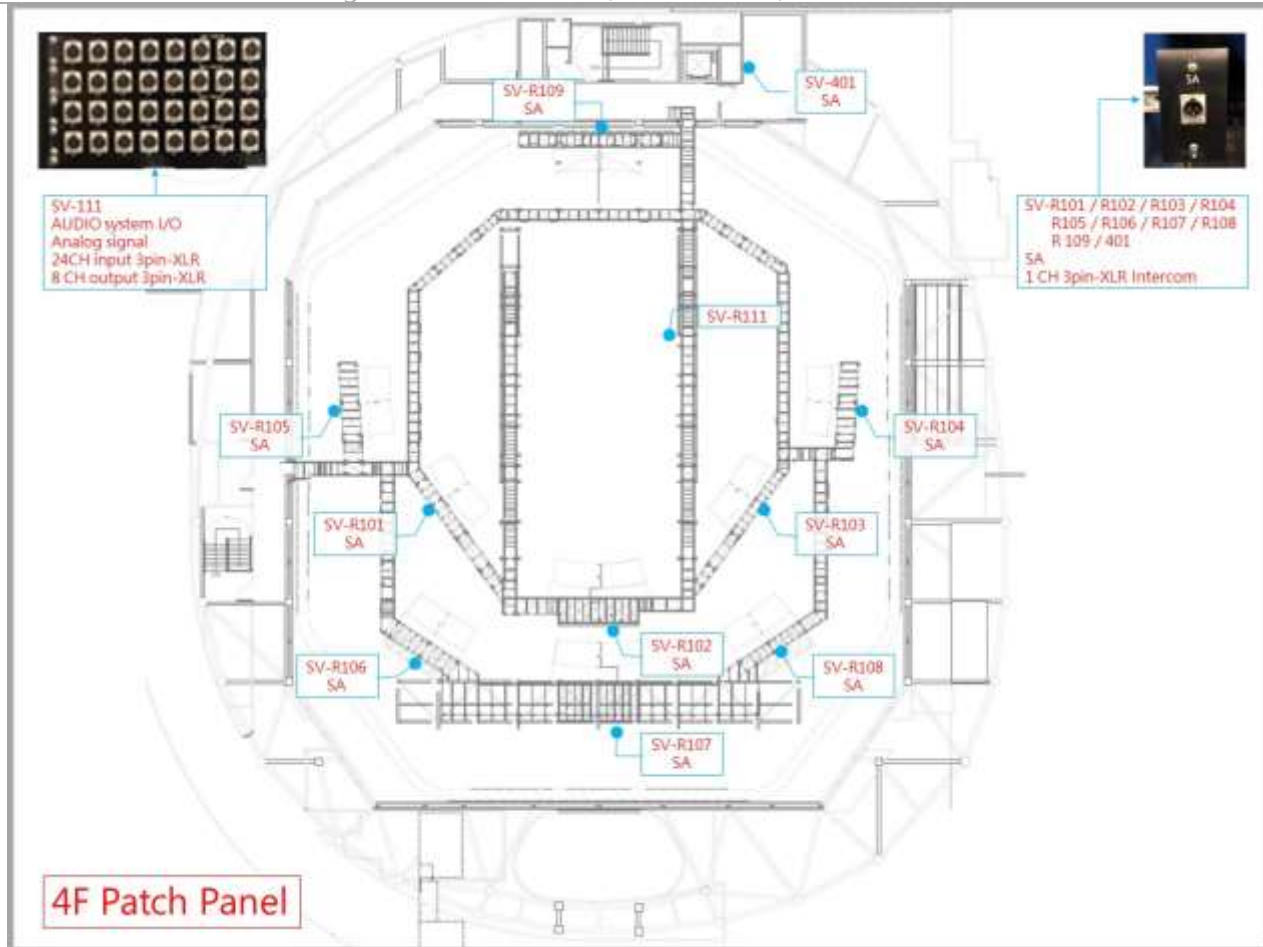

Figure 4-1.3 4F Audio system channel diagram

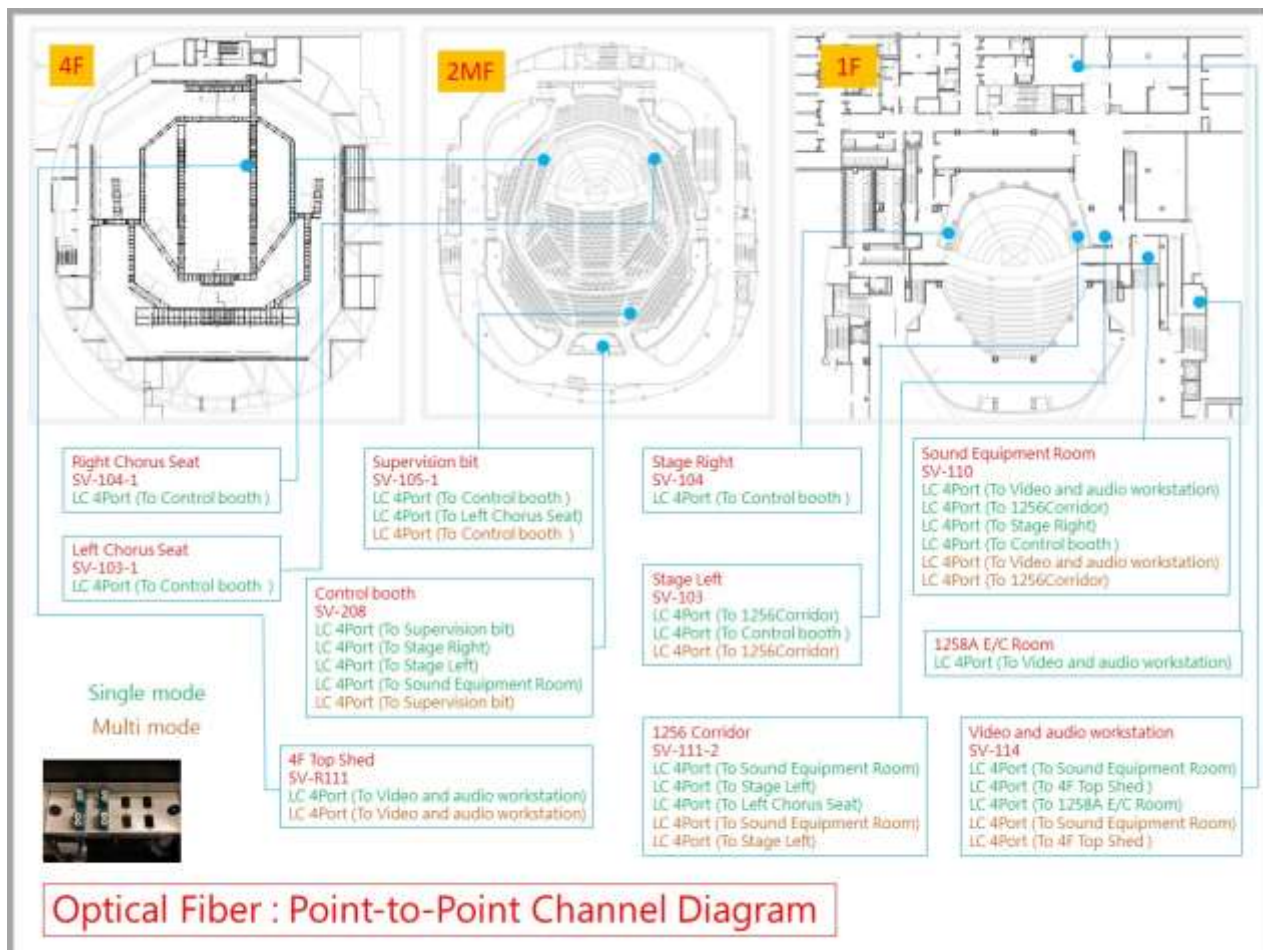

Figure 4-1.4 Optical fiber point-to-point channel diagram

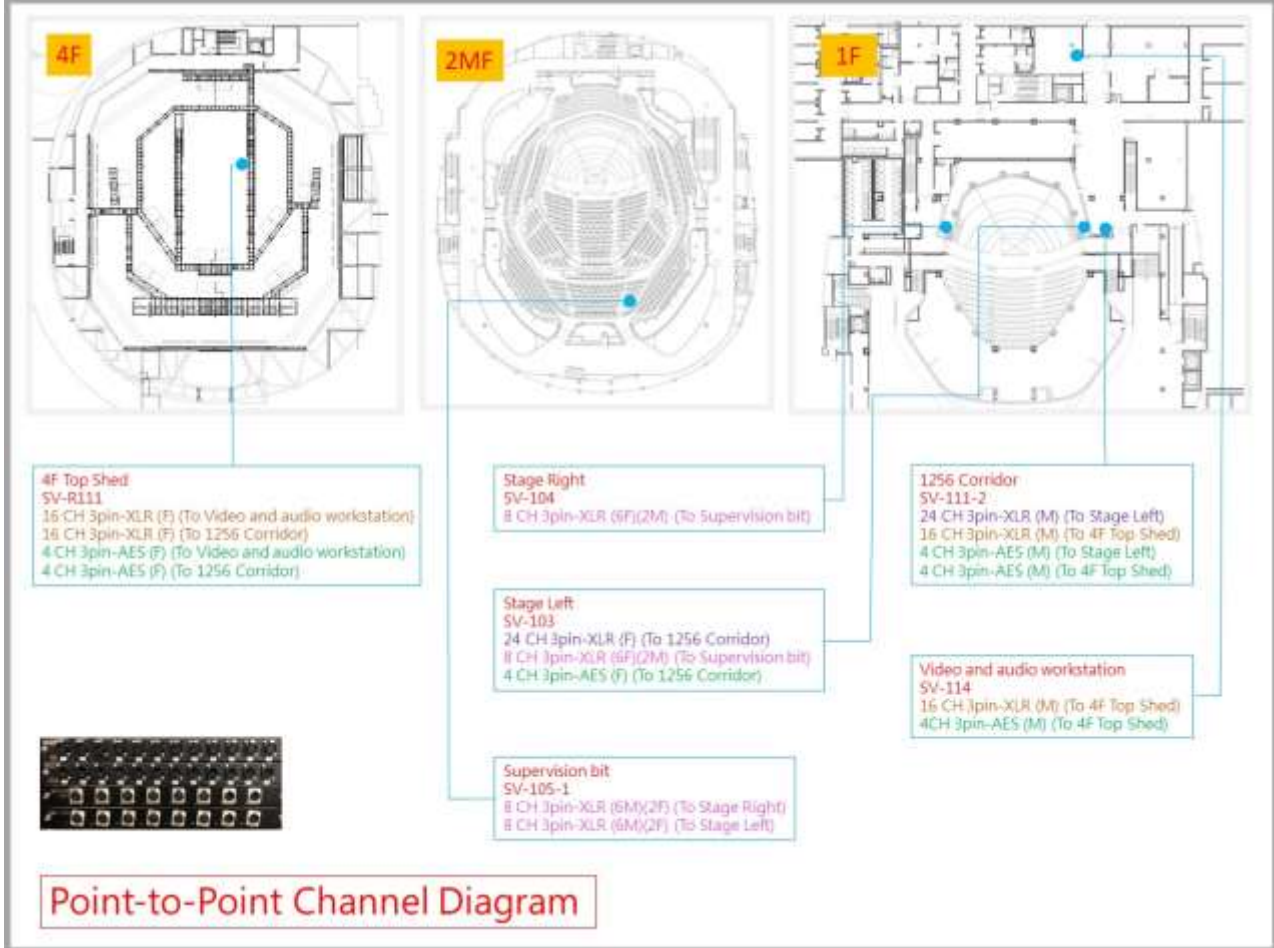

Figure 4-1.5 Signal point-to-point channel diagram

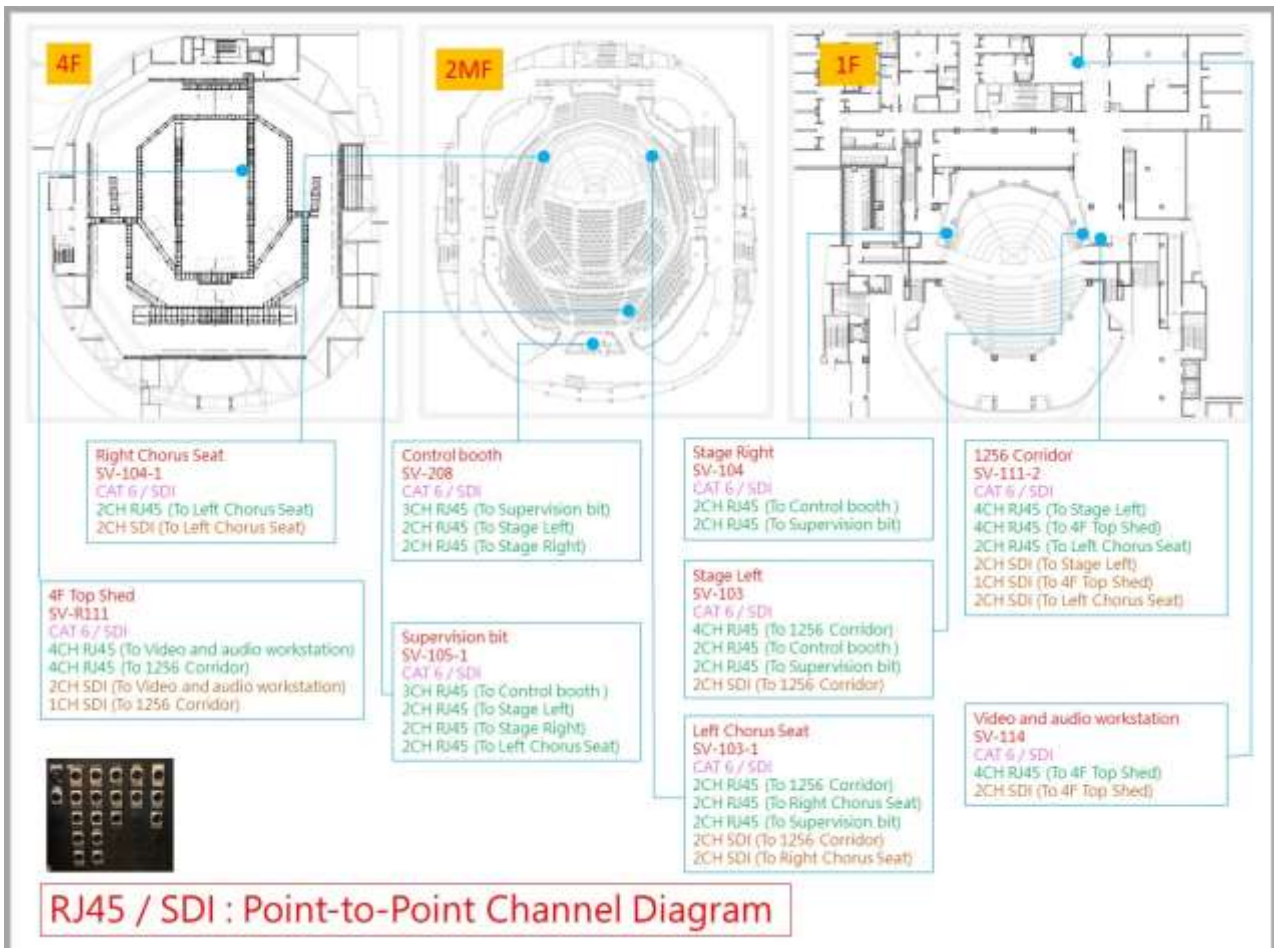

Figure 4-1.6 RJ45 / SDI point-to-point channel diagram

### 4-2 Control Room

| Item                           | Quantity | Brand and Model             | Paid Item |
|--------------------------------|----------|-----------------------------|-----------|
| Main Digital mixer             | 1        | Studer Vista 5 M3/42        |           |
| Digital I/O Fiber Module       | 1        | Studer D21M                 |           |
| CD PLAYER                      | 1        | Tascam CD-500B              | *         |
| CD-R PLAYER                    | 1        | Tascam CD-RW 901 MKII       | *         |
| Multitrack Recording equipment | 1        | Joeco BBR1D+2.5" USB 1TB HD | *         |
| Dual track Hard disk recorder  | 1        | Tascam DA 3000              | *         |
| Active speakers                | 4        | Dynaudio BM12 MkIII         |           |

Items with \* mark are paid items. Please refer to the rate tables of National Kaohsiung Center for the Arts.

### 4-3 Stage Manager's Console

The stage manager desk equips with a live sound monitor, video monitors, synchronous show screens with lighting and fly, communication system and paging system.

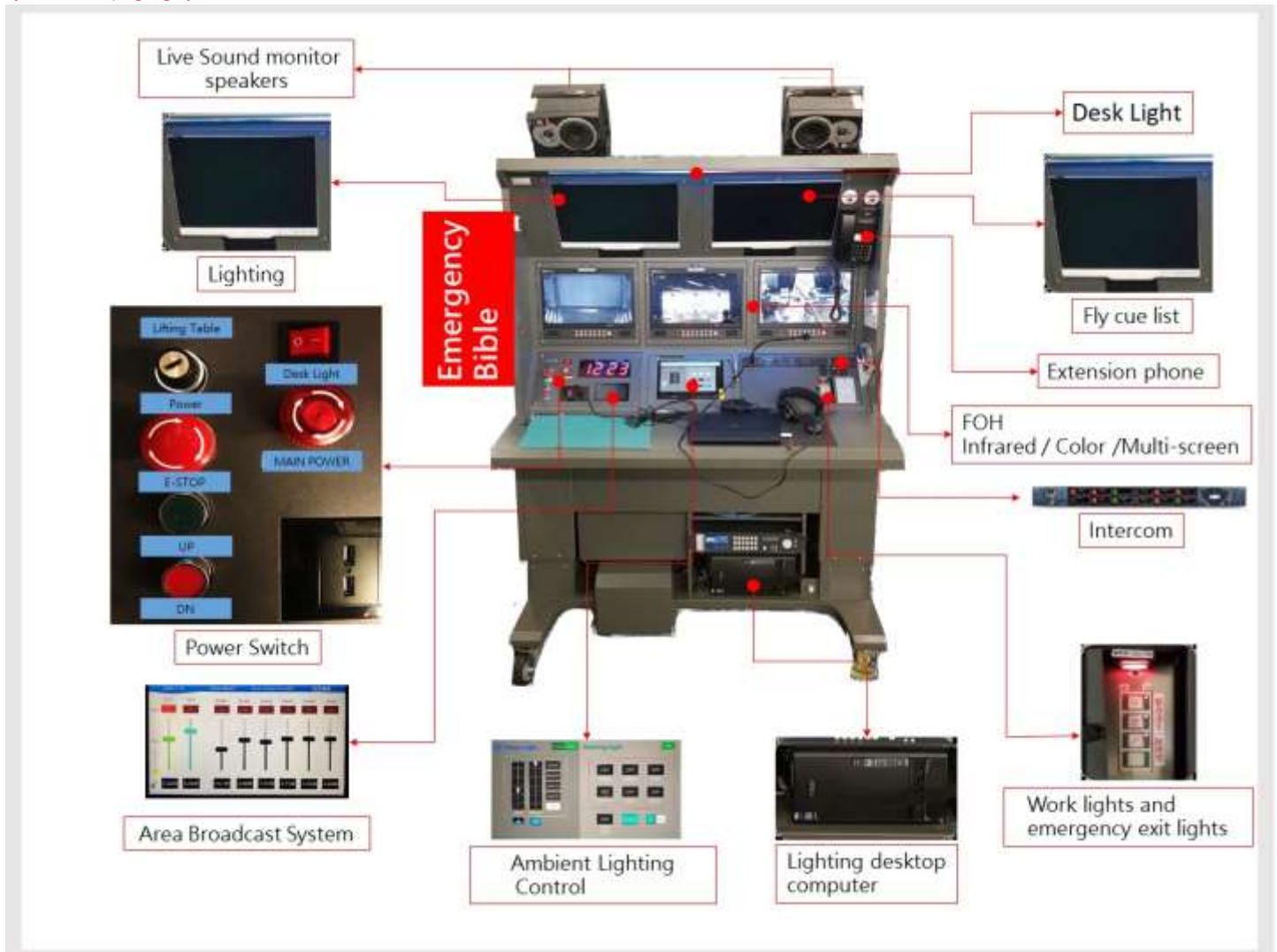

Figure 4-3.1 Stage Manager's Console

### 4-4 Microphone

| Item                                                           | Quantity | Brand and Model                                                                                                                                                                                                                                                                                                               | Paid Item |
|----------------------------------------------------------------|----------|-------------------------------------------------------------------------------------------------------------------------------------------------------------------------------------------------------------------------------------------------------------------------------------------------------------------------------|-----------|
| Condenser microphone<br>Neumann U87 Ai Studio Set              | 1        | Neumann U87 Ai Studio Set<br>Accessories : 1.EA 87 2.WS 87                                                                                                                                                                                                                                                                    | *         |
| Condenser microphone<br>Neumann KM184                          | 8        | Neumann KM184<br>Accessories : 1.SG 21 bk 2.WNS 100                                                                                                                                                                                                                                                                           |           |
| Condenser microphone<br>DPA 2011C/MMP-C                        | 4        | DPA 2011C/MMP-C                                                                                                                                                                                                                                                                                                               |           |
| Condenser microphone<br>DPA 4099-DC-1(For Loud SPL)/DAD6001-BC | 8        | DPA 4099-DC-1(For Loud SPL)/DAD6001-BC<br>Accessories :<br>1. Double Bass(BC4099) x 2<br>2. Cello(CC4099) x 2<br>3. Piano(PC4099) x 2<br>4. Clamp(CM4099) x 2<br>5. Guitar(GC4099) x 4<br>6. Sax and Trumpet(STC4099) x 2<br>7. MIC Stand(MS4099) x 1<br>8. Microphone Clip(UC4099) x 2<br>9. Violin and Mandolin(VC4099) x 8 |           |
| Dynamic microphone                                             | 2        | Audio Technica AE4100                                                                                                                                                                                                                                                                                                         | *         |
| Dynamic microphone                                             | 6        | Audio Technica ATM250                                                                                                                                                                                                                                                                                                         | *         |
| Condenser microphone                                           | 2        | Audio Technica AE5400                                                                                                                                                                                                                                                                                                         | *         |
| Cardioid Condenser microphone                                  | 6        | Audio Technica AT4021                                                                                                                                                                                                                                                                                                         | *         |
| Cardioid Condenser Boundary Microphone                         | 4        | Audio Technica U851R                                                                                                                                                                                                                                                                                                          | *         |
| Stage reception Microphone                                     | 2        | DPA 4017B / DPA UA0836 Holders                                                                                                                                                                                                                                                                                                |           |
| Hypercardioid Condenser microphone                             | 8        | AKG CK63-ULS+ C480B                                                                                                                                                                                                                                                                                                           | *         |
| Cardioid condenser microphone                                  | 8        | AKG CK61-ULS + C480B                                                                                                                                                                                                                                                                                                          | *         |
| Wireless system-Handheld microphone                            | 4        | Sennheiser SKM500G3+MME865                                                                                                                                                                                                                                                                                                    | *         |
| Wireless system-Lavalier microphone                            | 8        | Sennheiser SK500G3+MKE2                                                                                                                                                                                                                                                                                                       | *         |
| Single channel wireless microphone receiver                    | 12       | Sennheiser EW500G3                                                                                                                                                                                                                                                                                                            |           |
| Directional antenna                                            | 2        | Sennheiser AD3700                                                                                                                                                                                                                                                                                                             |           |
| Antenna Splitter                                               | 3        | Sennheiser ASA1                                                                                                                                                                                                                                                                                                               |           |

Items with \* mark are paid items. Please refer to the rate tables of National Kaohsiung Center for the Arts.

### 4-5 Communications

| Item                             | Quantity | Brand and Model                                                                                | Paid Item |
|----------------------------------|----------|------------------------------------------------------------------------------------------------|-----------|
| Intercom host machine            | 1        | Clear-Com Eclipse HX-Delta                                                                     |           |
| System interface                 | 1        | Clear-Com Helixnet HMS-4X                                                                      |           |
| Double circuit intercom          | 7        | Clear-Com Helixnet HBP-2X                                                                      |           |
| Fixed intercom microphone/ speak | 1        | Clear-Com V12PDXY 110 / 340<br>Clear-Com V12PDDXY 110 / 340                                    |           |
| Single head receiver microphone  | 4        | Clear-Com CC-300                                                                               |           |
| Double head receiver microphone  | 3        | Clear-Com CC-400                                                                               |           |
| Telephone intercom               | 4        | Clear-Com HS-6                                                                                 |           |
| Digital Wireless Intercom set    | 4        | 1. Portable wireless sub-station / Clear Com FS BP<br>2. Single-ear headset / Clear Com CC 300 | *         |

Items with \* mark are paid items. Please refer to the rate tables of National Kaohsiung Center for the Arts.

### 4-6 Locations of Communications

Each floor is paired with intercom system, 27units in total.

| Item Number | Floor               | Location                                |                     |
|-------------|---------------------|-----------------------------------------|---------------------|
| 1           | B1F                 | Storage room                            |                     |
| 2           | 1F                  | Stage left preparation area             |                     |
| 3           |                     | Stage right preparation area            |                     |
| 4           |                     | Stage left                              |                     |
| 5           |                     | Stage right                             |                     |
| 6           |                     | Auditorium seating area 12 row          |                     |
| 7           |                     | Loading Dock                            |                     |
| 8           |                     | Sound room                              |                     |
| 9           |                     | Recording studio                        |                     |
| 10          |                     | Green room 1                            |                     |
| 11          |                     | Dressing room 2                         |                     |
| 12          |                     | Dressing room 3                         |                     |
| 13          |                     | Dressing room 4                         |                     |
| 14          |                     | 2MF                                     | Master control room |
| 15          |                     |                                         | Master control room |
| 16          | Deputy Control Room |                                         |                     |
| 17          | 4F                  | Dimmer room                             |                     |
| 18          |                     | Amplifier room                          |                     |
| 19          | R1F                 | Catwalk 1 <sup>st</sup> (Lightingopen4) |                     |
| 20          |                     | Catwalk 1 <sup>st</sup> (Lightingopen5) |                     |
| 21          |                     | Catwalk 1 <sup>st</sup> (Lightingopen6) |                     |
| 22          |                     | Catwalk 1 <sup>st</sup> (Lightingopen7) |                     |
| 23          |                     | Catwalk 2 <sup>st</sup> (Lightingopen8) |                     |
| 24          |                     | Catwalk 2 <sup>st</sup> (Lightingopen9) |                     |
| 25          |                     | Stageright Box(Lightingopen3)           |                     |
| 26          |                     | Stageleft Box(Lightingopen2)            |                     |
| 27          |                     | Catwalk(Lightingopen1)                  |                     |

### 4-7 Stage Cameras and Video Surveillance Systems

Stage monitors are installed in right and left stage entrances, first, second, and third floor lobbies, master and secondary control rooms, dressing rooms and green rooms.

| Item                     | Quantity | Brand and Model                                                                   | Paid Item |
|--------------------------|----------|-----------------------------------------------------------------------------------|-----------|
| Camera ( 2/3 inch 3CCD ) | 2        | Panasonic AW-HE870<br>Panasonic LZ20M85G                                          |           |
| Remote control           | 1        | Panasonic AW-RP50                                                                 |           |
| Switcher                 | 1        | Panasonic AW-RP120                                                                |           |
| Video recording          | Show     | Fixed camera for stage panoramic view recording, only suitable for archived copy. |           |

Items with \* mark are paid items. Please refer to the rate tables of National Kaohsiung Center for the Arts.

### 4-8 Paging Systems

#### Backstage Paging Systems

Backstage Paging Systems available for all dressing rooms, green rooms, Company office and Corridors, see next page. The Paging and Program position is located on the Stage Manager Desk.

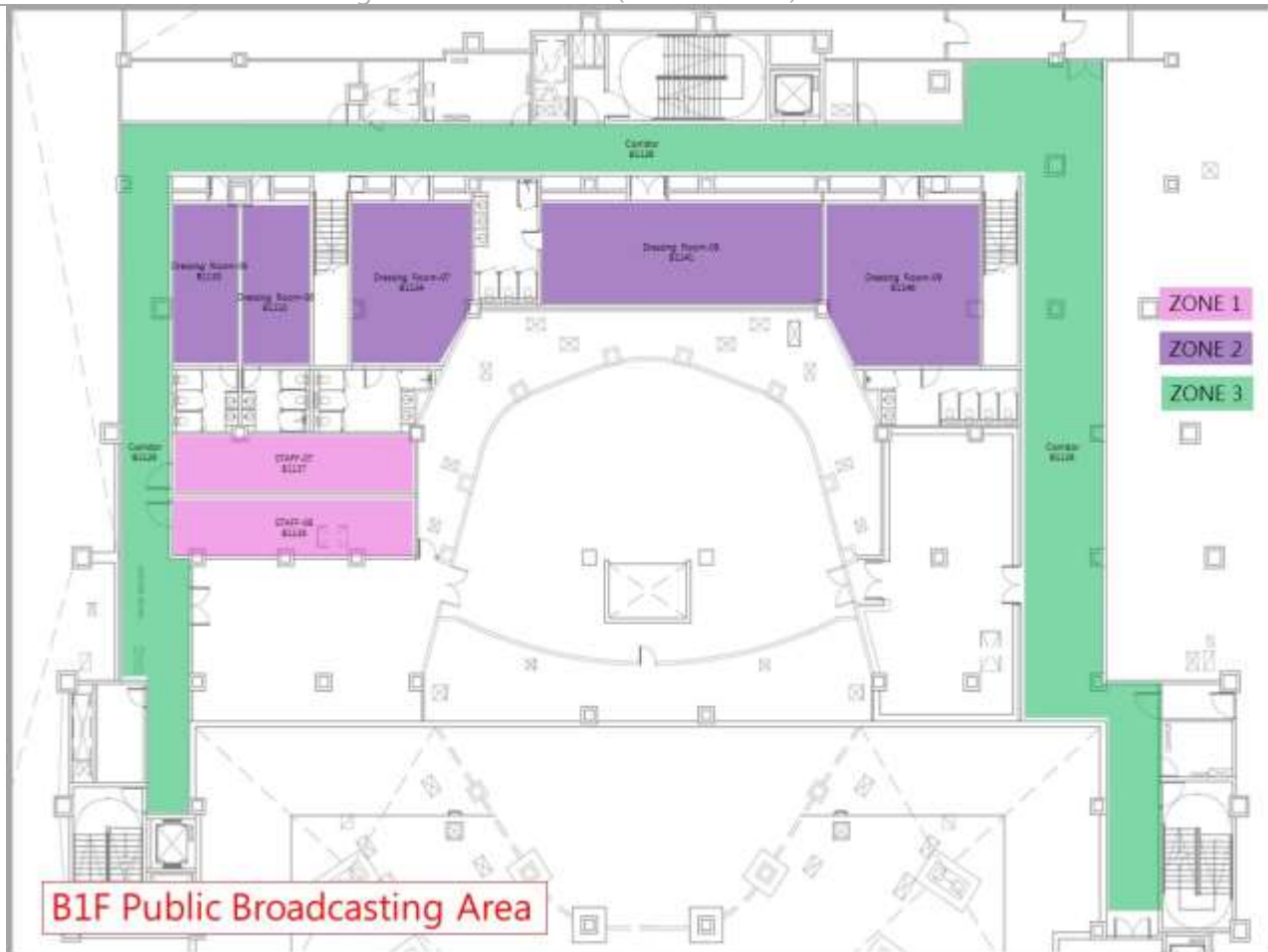

Figure 4-8.1- B1F public broadcasting area icon

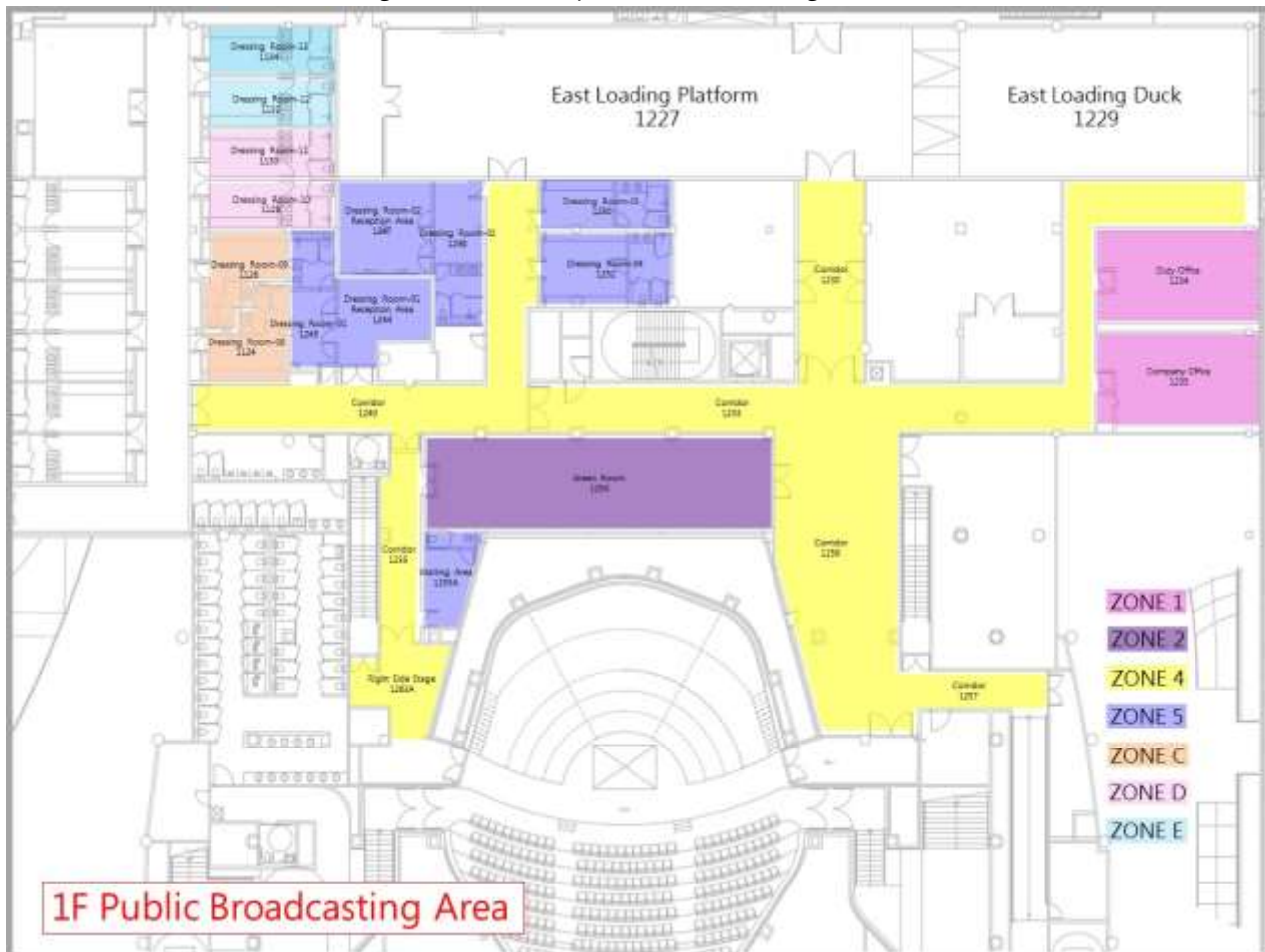

Figure 4-8.2 1F public broadcasting area icon

## 4-9 Projector

| Item                                                       | Quantity | Brand and Model                                                                                                                                                             | Paid Item         |
|------------------------------------------------------------|----------|-----------------------------------------------------------------------------------------------------------------------------------------------------------------------------|-------------------|
| Laser Projector/ Downlight type<br>(Dedicated to Subtitle) | 1        | 1. Panasonic(Space Player) x 2<br>2. Laptop x 2<br>3. Switcher x 1<br>Including assembly and disassembly, excluding operation<br>After second performance will discount 50% | *<br>Option 2     |
| 5K Lumens LCD Projector                                    | 2        | NEC PE501X                                                                                                                                                                  | *<br>Option 2     |
| 5K Lumens Laser Projector                                  | 2        | Optoma ZU500USTe<br>Projection distance (45.7cm 132 inches - 58.3cm 155 inches)                                                                                             | *<br>Option 2     |
| 6K Lumens Laser Projector                                  | 2        | Panasonic PT-VMZ60T · Wide-angle lens(Zoom)<br>Lens : throw ratio 1.09 -1.77 : 1                                                                                            | *<br>Option 2     |
| 10K Lumens Laser Projector                                 | 2        | Panasonic PT-RCQ10 · Normal lens(Zoom)<br>Lens : throw ratio 1.71~2.41 : 1                                                                                                  | *<br>Option 2     |
| Ultra Short-Throw Lens                                     | 1        | ET-DLE020 · Lens : throw ratio 0.28~0.299 : 1<br>(For Panasonic PT-RCQ10 only)                                                                                              | *<br>Option 2     |
| 30K Lumens Laser Projector                                 | 2        | Panasonic PT-RQ35K with optional lens<br>ET-D3LEW60 (throw ratio : 0.991-1.18:1)<br>ET-D3LEW10 (throw ratio : 1.35-1.84:1)<br>ET-D3LES20 (throw ratio : 1.79-2.59:1)        | *<br>Option 2 · 3 |
| 17.3" Full HD LCD Monitor                                  | 2        | Datavideo TLM-170L                                                                                                                                                          | *<br>Option 1     |
| Projection Screen                                          | 4        | Grandview X-Press<br>Pull-UP 100-inch projection screen(W203cm*H152cm)                                                                                                      | *<br>Option 1     |

Items with \* mark are paid items. Please refer to the rate tables of National Kaohsiung Center for the Arts.

Option 1 : Setup and operating is not included !

Option 2 : Operating is not included !

Option 3 : Rental fee 50% off from second show.

## 5 Backstage

### 5-1 Dressing Room and Green Room

| No. | Floor | Room No. | Name             | Capacity | Notes                                                        |
|-----|-------|----------|------------------|----------|--------------------------------------------------------------|
| 1   | 1F    | 1235     | Company office   | 20       | Includes table and chairs.                                   |
| 2   |       | 1245     | Dressing room 01 | 3        | Includes mirror, tables and chairs, toilet and shower        |
| 3   |       | 1248     | Dressing room 02 | 2        | Includes mirror, tables and chairs, toilet and shower, piano |
| 4   |       | 1250     | Dressing room 03 | 3        | Includes mirror, tables and chairs, toilet and shower        |
| 5   |       | 1252     | Dressing room 04 | 5        | Includes mirror, tables and chairs, toilet and shower        |
| 6   |       | 1254     | Green room       | 30       | Includes dressing mirror, tables and chairs.                 |
| 7   | B1F   | B1130    | Dressing room 05 | 7        | Includes mirror, tables and chairs and toilet                |
| 8   |       | B1132    | Dressing room 06 | 7        | Includes mirror, tables and chairs, toilet and shower        |
| 9   |       | B1134    | Dressing room 07 | 13       | Includes mirror, tables and chairs, toilet and shower        |
| 10  |       | B1141    | Dressing room 08 | 29       | Includes mirror, tables and chairs, toilet and shower        |
| 11  |       | B1146    | Dressing room 09 | 20       | Includes mirror, tables and chairs, toilet and shower        |

### 5-2 Orchestra Facilities

| No. | Item                                      | Quantity | Notes                                                                                                                                                |
|-----|-------------------------------------------|----------|------------------------------------------------------------------------------------------------------------------------------------------------------|
| 1   | Music Chair                               | 150 *    | WENGER Musician Chair                                                                                                                                |
| 2   | Ensemble stool                            | 18 *     | Rotate : 6<br>Unable to rotate : 12                                                                                                                  |
| 3   | Conductor' s chair                        | 1 *      |                                                                                                                                                      |
| 4   | Music stand                               | 140 *    |                                                                                                                                                      |
| 5   | Music stand light                         | 60 *     | White light, two brightness mode                                                                                                                     |
| 6   | Conductor' s podium                       | 1 *      | WENGER<br>Double podium / Base podium:1.09 x 0.97 x 0.15 m<br>Double podium / Upper podium:0.81 x 0.97 x 0.15 m<br>Single podium:1.2 x 1.15 x 0.25 m |
| 7   | Conductor' s stand                        | 1        |                                                                                                                                                      |
| 8   | Percussion table stand                    | 8 *      |                                                                                                                                                      |
| 9   | Endpin stopper                            | 20 *     |                                                                                                                                                      |
| 10  | Acoustic shield                           | 5 *      |                                                                                                                                                      |
| 11  | Wooden Platform                           | 30 *     | Large L183cm*W138cm*H22cm*10<br>Medium L183cm*W92cm*H22cm*10<br>Small L183cm*W46cm*H22cm*10                                                          |
| 12  | Resonance Podium for Violin 100*60*15(cm) | 8 *      |                                                                                                                                                      |
|     | Resonance Podium for Violin 100*60*20(cm) | 8 *      |                                                                                                                                                      |
|     | Resonance Podium for Cello 130*60*15(cm)  | 4 *      |                                                                                                                                                      |
|     | Resonance Podium for Cello 130*60*20(cm)  | 4 *      |                                                                                                                                                      |
|     | Solo Musician' s Podium 175*100*20(cm)    | 1 *      |                                                                                                                                                      |
|     | Solo Musician' s Podium 115*110*15(cm)    | 1 *      |                                                                                                                                                      |

Items with \* mark are shared with Recital Hall.



**5-3 Pianos (shared between four venues)**

| No. | Item          | Brand                   | Model Number            | Quantity | Notes |
|-----|---------------|-------------------------|-------------------------|----------|-------|
| 1   | Concert grand | Steinway & Sons         | D-274                   | 3        | *     |
| 2   | Concert grand | FAZIOLI                 | F308                    | 1        | *     |
| 3   | Grand Piano   | YAMAHA                  | C7XPE                   | 1        | *     |
| 4   | Grand Piano   | KAWAI                   | SK-6L                   | 1        | *     |
| 5   | Harpsichord   | J.C.NEUPERT             | Hemsch                  | 1        | *     |
| 6   | Celesta       | Schiendmayer            | 5 ½ Octave Studio model | 1        | *     |
| 7   | Pipe Organ    | ORGELBAU KLAIS BONN     |                         | 1        | *     |
|     |               | ORGELBAU Johannes KLAIS | Portable Pipe Organ     | 1        | *     |
| 8   | Upright Piano | YAMAHA                  | U3                      | 1        | *     |

Items with \* mark are paid items. Please refer to the rate tables of National Kaohsiung Center for the Arts.

**Important :**

1. Pianos shared with four venues, booking in advance is required.
2. WeiWuYing's contract-signed piano technician must tune all pianos before performance. (Piano hire fees do not include tuning costs)
3. Extra material (any object touching the strings during the performance, including hands or palms) pianos are limited to YAMAHA C7XPE and KAWAI SK-6L, which should be restored and tuned by the venue's contracted tuner at the end of the performance (at the latest on the next day) at the expense of the applicant.
4. While WWY' s piano is in part of the performance, the Fog and Haze Machine can' t be used.

5-4 Pipe Organ

Kaohsiung/TWN, National Kaohsiung Center for the Arts

| Symphonic Organ: V/102, mech.+elektr./elektr. |        |                                         |        | Classic Organ: II/25, mech.+elektr./elektr. |        |
|-----------------------------------------------|--------|-----------------------------------------|--------|---------------------------------------------|--------|
| <b>I. POSITIF EXPRESSIF C-c<sup>4</sup></b>   |        | Hautbois                                | 8'     | Flûte                                       | 4'     |
| Quintaton                                     | 16'    | Voix humaine                            | 8'     | Petite Quinte                               | 2 2/3' |
| Montre                                        | 8'     | Clairon                                 | 4'     | Petite Flûte                                | 2'     |
| Salicional                                    | 8'     | Trémolo                                 |        | Piccolino                                   | 1'     |
| Bourdon                                       | 8'     | <b>IV. GRAND-CHOEUR C-c<sup>4</sup></b> |        | Mixture VI                                  | 2 2/3' |
| Unda maris                                    | 8'     | Principal                               | 8'     | Contre Bombarde                             | 32'    |
| Flûte ouverte                                 | 4'     | Bourdon                                 | 8'     | Bombarde I                                  | 16'    |
| Violon                                        | 4'     | Octave                                  | 4'     | Bombarde II (SO)                            | 16'    |
| Chœur de Violes VI                            | 2 2/3' | Nazard                                  | 2 2/3' | Trompette I                                 | 8'     |
| Basson                                        | 16'    | Quarte                                  | 2'     | Trompette II (SO)                           | 16'    |
| Hom                                           | 8'     | Tierce                                  | 1 3/5' | Clairon                                     | 4'     |
| Chœur de Rossignols                           |        | Larigot                                 | 1 1/3' | <b>KOPPELN/COUPLERS</b>                     |        |
| Trémolo                                       |        | Septième                                | 1 1/7' | Tirasse Positif expressif (I-P)             |        |
| <b>II. GRAND-ORGUE C-c<sup>4</sup></b>        |        | Sifflet                                 | 1'     | Tirasse Grand-orgue (II-P)                  |        |
| Montre                                        | 16'    | Grosse Fourmiture VI                    | 2 2/3' | Tirasse Récit expressif (III-P)             |        |
| Bourdon                                       | 16'    | Cymbale VI                              | 1'     | Tirasse Grand-choeur (IV-P)                 |        |
| Montre                                        | 8'     | Grosse Trompette                        | 8'     | Tirasse Solo (V-P)                          |        |
| Salicional                                    | 8'     | Cromorne                                | 8'     | Tirasse Chamades (CH-P)                     |        |
| Flûte harmonique                              | 8'     | Gros Clairon                            | 4'     | Grand-orgue au Positif (II-I)               |        |
| Bourdon                                       | 8'     | Trémolo                                 |        | Récit au Positif expressif (III-I)          |        |
| Grosse Quinte                                 | 5 1/3' | <b>V. SOLO C-c<sup>4</sup></b>          |        | Grand-choeur au Positif (IV-I)              |        |
| Prestant                                      | 4'     | Flûte majeur                            | 8'     | Solo au Positif expressif (I-P)             |        |
| Flûte ouverte                                 | 4'     | Gambe                                   | 8'     | Chamades au Positif expressif (CH-I)        |        |
| Grosse Tierce                                 | 3 1/5' | Voix céleste                            | 8'     | Positif au Grand-orgue (I-II)               |        |
| Quinte                                        | 2 2/3' | Flûte de Concert                        | 4'     | Récit au Grand-orgue (III-II)               |        |
| Septième                                      | 2 2/7' | Grande Bombarde                         | 16'    | Grand-choeur au Grand-orgue (IV-II)         |        |
| Doublette                                     | 2'     | Trompette                               | 8'     | Solo au Grand-orgue (V-II)                  |        |
| Cornet V                                      | 8'     | Cor anglais                             | 8'     | Grand-choeur au Récit (IV-III)              |        |
| Fourmiture VI                                 | 2'     | Clairon                                 | 4'     | Solo au Récit (V-III)                       |        |
| Cymbale VI                                    | 1 1/3' | Chamade                                 | 16'    | Chamades au Récit (Ch-III)                  |        |
| Bombarde                                      | 16'    | Chamade                                 | 8'     | Solo au Grand-choeur (V-IV)                 |        |
| Trompette                                     | 8'     | Chamade                                 | 4'     | Chamades au Grand-choeur (Ch-IV)            |        |
| Chamade (SO)                                  | 16'    | <b>PÉDALE C-g<sup>1</sup></b>           |        | Octaves graves Positif (Sub in I)           |        |
| Chamade (SO)                                  | 8'     | Voix de baleine                         | 64'    | Octaves aiguës Positif (Super in I)         |        |
| Chamade (SO)                                  | 4'     | Flûte                                   | 32'    | Octaves graves Grand-orgue (Sub in II)      |        |
| <b>III. RÉCIT EXPRESSIF C-c<sup>4</sup></b>   |        | Scoubasse                               | 32'    | Octaves aiguës Grand-orgue (Super in II)    |        |
| Bourdon                                       | 16'    | Basse acoustique                        | 32'    | Octaves graves Récit (Sub in III)           |        |
| Diapason                                      | 8'     | Flûte                                   | 16'    | Octaves aiguës Récit (Super in III)         |        |
| Flûte harmonique                              | 8'     | Principal-Basse (G-O)                   | 16'    | Octaves graves Grand-choeur (Sub in IV)     |        |
| Viole de Gambe                                | 8'     | Scoubasse                               | 16'    | Octaves aiguës Grand-choeur (Super in IV)   |        |
| Voix céleste                                  | 8'     | Bourdon (G-O)                           | 16'    | Octaves graves Solo (Sub in V)              |        |
| Octave                                        | 4'     | Grosse Quinte                           | 10'    | Octaves aiguës Solo (Super in V)            |        |
| Flûte octavjante                              | 4'     |                                         | 2/3'   |                                             |        |
| Nazard harmonique                             | 2 2/3' | Flûte                                   | 8'     |                                             |        |
| Octavin                                       | 2'     | Octave                                  | 8'     |                                             |        |
| Tierce harmonique                             | 1 3/5' | Bourdon                                 | 8'     |                                             |        |
| Carillon IV                                   | 2 2/3' | Grosse Tierce                           | 6 2/5' |                                             |        |
| Cornet harmonique V                           | 8'     | Quinte                                  | 5 1/3' |                                             |        |
| Bombarde                                      | 16'    | Septième                                | 4 4/7' |                                             |        |
| Trompette harmonique                          | 8'     | Octave                                  | 4'     |                                             |        |
|                                               |        |                                         |        | <b>II. OBERWERK C-c<sup>4</sup></b>         |        |
|                                               |        |                                         |        | Gedackt                                     | 8'     |
|                                               |        |                                         |        | Quintadena                                  | 8'     |
|                                               |        |                                         |        | Principal                                   | 4'     |
|                                               |        |                                         |        | Rohrflöte                                   | 4'     |
|                                               |        |                                         |        | Waldflöte                                   | 2'     |
|                                               |        |                                         |        | Quinte                                      | 1 1/3' |
|                                               |        |                                         |        | Sesquialtera II                             | 2 2/3' |
|                                               |        |                                         |        | Scharff IV                                  | 1'     |
|                                               |        |                                         |        | Dulcian                                     | 8'     |
|                                               |        |                                         |        | Tremulant                                   |        |
|                                               |        |                                         |        | <b>PEDAL C-g<sup>1</sup></b>                |        |
|                                               |        |                                         |        | Subbass                                     | 16'    |
|                                               |        |                                         |        | Principal                                   | 8'     |
|                                               |        |                                         |        | Gedackt                                     | 8'     |
|                                               |        |                                         |        | Octave                                      | 4'     |
|                                               |        |                                         |        | Hintersatz IV                               | 2 2/3' |
|                                               |        |                                         |        | Fagott                                      | 16'    |
|                                               |        |                                         |        | Trompette                                   | 8'     |
|                                               |        |                                         |        | <b>KOPPELN/COUPLERS</b>                     |        |
|                                               |        |                                         |        | II - I                                      |        |
|                                               |        |                                         |        | I - P                                       |        |
|                                               |        |                                         |        | II - P                                      |        |
|                                               |        |                                         |        | Generalspieltische /                        |        |
|                                               |        |                                         |        | General Consoles:                           |        |
|                                               |        |                                         |        | Hauptwerk - I                               |        |
|                                               |        |                                         |        | Hauptwerk - II                              |        |
|                                               |        |                                         |        | Hauptwerk - III                             |        |
|                                               |        |                                         |        | Hauptwerk - IV                              |        |
|                                               |        |                                         |        | Hauptwerk - V                               |        |
|                                               |        |                                         |        | Hauptwerk - P                               |        |
|                                               |        |                                         |        | Oberwerk - I                                |        |
|                                               |        |                                         |        | Oberwerk - II                               |        |
|                                               |        |                                         |        | Oberwerk - III                              |        |
|                                               |        |                                         |        | Oberwerk - IV                               |        |
|                                               |        |                                         |        | Oberwerk - V                                |        |
|                                               |        |                                         |        | Oberwerk - P                                |        |

### 5-5 Loading Dock/ Scenery Shipping Path / Loading Flow

#### 5-5-1 East Dock

Recital Hall and Concert Hall use the East Dock for loading and unloading. The dock is equipped with two hydraulic dock leveler that can be adjusted according to the required height.

**Dock Dimension**

Dimension: 8.75m (width)

Clearance: 4.3m height from floor to top

3.8m height from dock to grid area (Truck height limit 4.2m)

Height from dock to floor: 0.98m

Stage entrance: minimum 1.95m (width) x 2.2m (height)

**※Notes for Container Transport:**

Due to the limitation of the slope at the entry of the loading dock, the minimum height of the trailer's low bed should be higher than 100cm. Also, if the company hires a 40' high-cube container, the bed rack should be within the height of 135~140cm to accommodate the height of loading gate.

#### 5-5-2 Handling equipment

1.5mt Stand-Up Automatic Electric Forklift x1

3mt Manual Hydraulic Pallet Jack x1

\* If you need to use the forklift, please contact us.

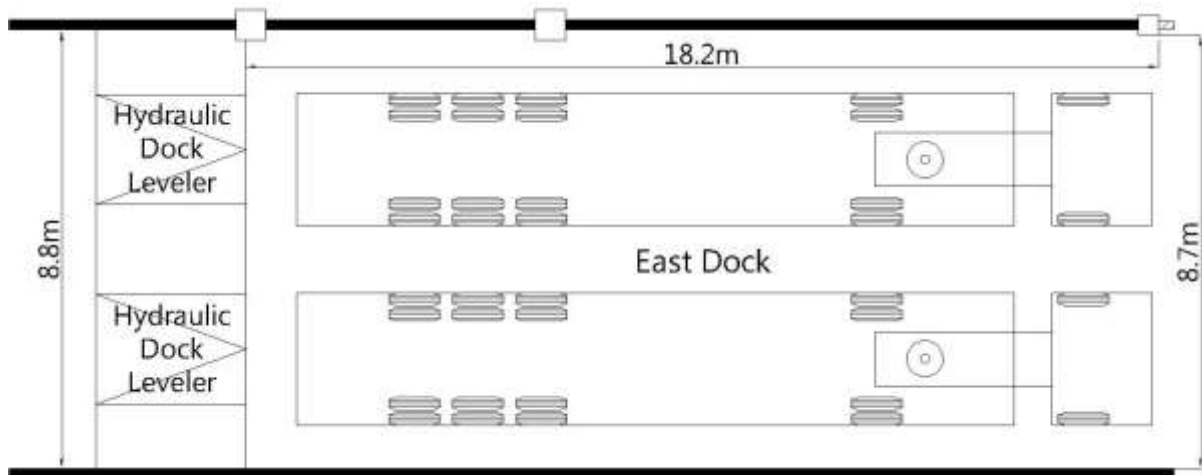

Figure 5.1- East Loading Dock Plan

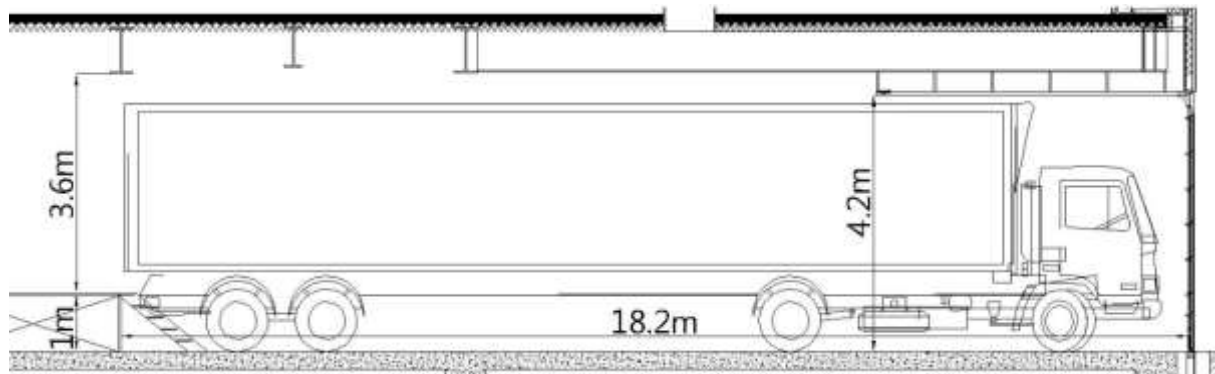

Figure 5.2- East Loading Dock Section

5-5-3 Loading Flow

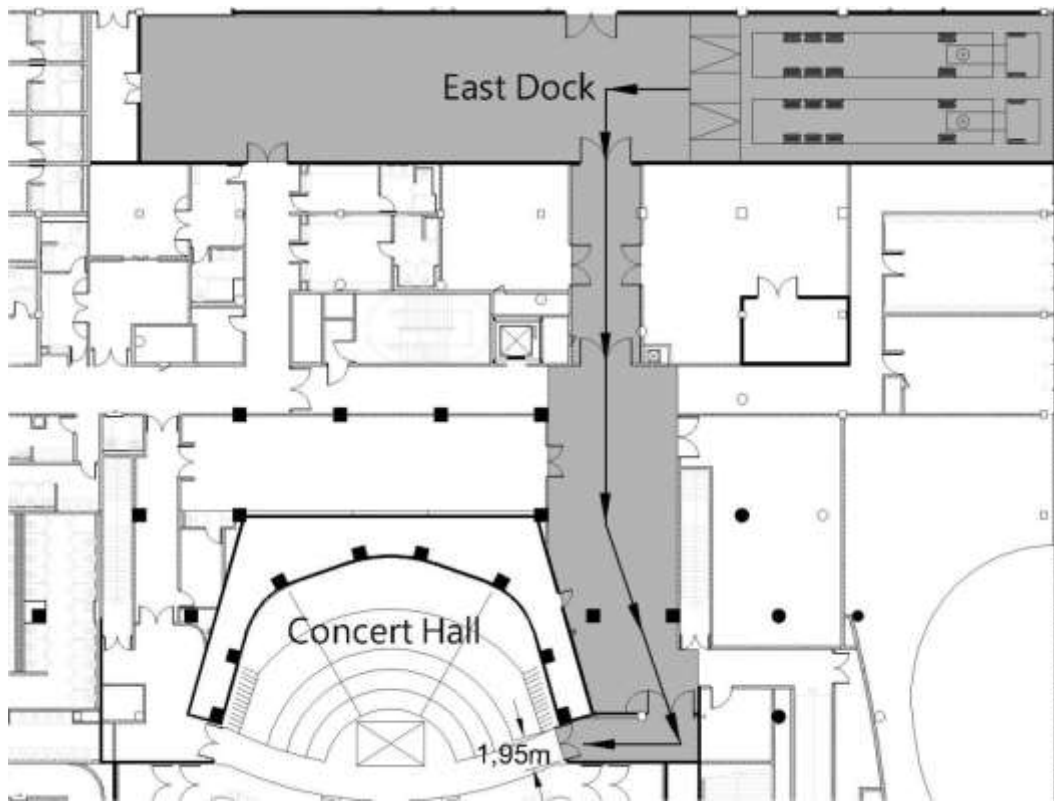

Figure 4.3 - Loading Flow

5-5-4 Hydraulic Dock Leveler

- Capacity: 22.6mt
- Area: 198cm (width) x 221.9cm (length)
- Elevation: +/- 30.5cm
- Quantity: 2

## 5-6 Other Facilities

### 5-6-1 Rehearsal Rooms

There is no rehearsal studio dedicated to the Concert Hall. Additional rehearsal space is limited across the WEIWUYING. There are 13 different function and accommodated rehearsal studios, these available for hire between four major theatres .Requests should be discussed well in advance to determine availability. The hire fees please refer to the rate tables of National Kaohsiung Center for the Arts.

| Room No. | Name                       | Dimension<br>(Length x Width x Height / m) | Notes                                                                                                                                                                      |
|----------|----------------------------|--------------------------------------------|----------------------------------------------------------------------------------------------------------------------------------------------------------------------------|
| 1182     | Medium Rehearsal Studio-02 | 11.4x10.8x3.8                              | 1. Wooden floor covered gray color dance floor, Sound absorption wall x 2 side, Wall mount glassless mirrors x 2 side<br>2. Capacity : 50                                  |
| 1184     | Medium Rehearsal Studio-03 | 11.1x10.8x4                                | 1. Grand Piano, Wooden floor covered gray color dance floor, Sound absorption wall x 2 side, Wall mount glassless mirrors x 2 side<br>2. Capacity : 50                     |
| 1186     | Large Rehearsal Studio-04  | 17.5x12.1x3.9                              | 1. Grand Piano, Wooden floor, Black color dance floor, Wall mount glassless mirrors x 2 side, Fixed Ballet barre on the single sided wall mirror x 2<br>2. Capacity : 110  |
|          |                            | Subsidiary space 6.6×8.8 ×3                | Rehearsal Studio-04 use only<br>GreenRoom-01(With dressing room)                                                                                                           |
| 1192     | Large Rehearsal Studio-05  | 19.3x12.2x3.9                              | 1. Grand Piano, Wooden floor , Black color dance floor, Wall mount glassless mirrors x 2 side, Fixed Ballet barre on the single sided wall mirror x 2<br>2. Capacity : 110 |
|          |                            | Subsidiary space 6.6×8.8 ×3                | Rehearsal Studio-05 use only<br>Green Room-02(With dressing room)                                                                                                          |
| B1111    | Small Rehearsal Studio-06  | 87.4x2.3                                   | 1. Upright piano, Chair, Music stand, Wooden floor, Sound absorption wall<br>2. Capacity : 25                                                                              |
| B1112    | Small Rehearsal Studio-07  | 5.2x4.4x2.3                                | 1. Chair, Music stand, Wooden floor, Sound absorption wall<br>2. Capacity : 10                                                                                             |
| B1113    | Small Rehearsal Studio-08  | 7.2x5x2.7                                  | 1. Chair , Music stand, Wooden floor, Sound absorption wall<br>2. Capacity : 15                                                                                            |
| B1114    | Small Rehearsal Studio-09  | 5.2x3.7x2.7                                | 1. Chair, Music stand, Wooden floor, Sound absorption wall<br>2. Capacity : 10                                                                                             |
| B1115    | Small Rehearsal Studio-10  | 5.2x4.1x2.7                                | 1. Chair , Music stand, Wooden floor, Sound absorption wall<br>2. Capacity : 10                                                                                            |
| B1116    | Small Rehearsal Studio-11  | 5.2 x 4.1 x 2.7                            | 1. Chair , Music stand, Wooden floor, Sound absorption wall<br>2. Capacity : 10                                                                                            |
| B304     | Chorus Rehearsal Room      | 15.9x9.9x8.8                               | 1. Grand Piano, Chair, Ensemble stool, Wooden floor, Sound absorption curtain<br>2. Capacity : 80                                                                          |
| B313     | Orchestra Studio           | 18.7x14.3x7.8                              | 1. Fixed auditorium < 84seats >, Grand Piano, Chair, Ensemble stool, Wooden floor, Sound absorption curtain<br>2. Capacity : 200                                           |

### 5-6-2 Carpentry Shop / Costume Shop / Laundry Room

National Kaohsiung Center for the Arts is equipped with basic production facilities, include Carpentry Shop, Costume Shop, and laundry rooms. Those for hire between four major theatres. The hire fees please refer to the rate tables of National Kaohsiung Center for the Arts.

| Room No. | Name            | Dimension<br>(Length x Width x Height / m) | Notes                                                                                                           |
|----------|-----------------|--------------------------------------------|-----------------------------------------------------------------------------------------------------------------|
| 1002     | Carpentry Shop  | 11.9×19.7×3                                | Basic wood crafts and electrical tools                                                                          |
| 1165     | Costume Shop-01 | 5.9×10.2×3                                 | Basic facilities for the maintenance of costume;<br>Sewing machine, overlock machine and steam / iron equipment |
| 1181     | Costume Shop-02 | 5.8×11.8×3                                 |                                                                                                                 |
| B1022    | Costume Shop-03 | 5.4×3.7×2.5                                |                                                                                                                 |
| 1163     | Laundry Room-01 | 5.8×4.9×3                                  | Washing machine, tumble dryers, sink and clothes folding table                                                  |
| B1019    | Laundry Room-02 | 6×8.2×3                                    |                                                                                                                 |